

M1 Series Windrower
Harvest Performance Tracker Display Kit (MD #306360)
INSTALLATION INSTRUCTIONS

If the Harvest Performance Tracker (HPT) display module on a MacDon M1 Series Windrower is faulty or damaged, it can be replaced with the Harvest Performance Tracker Display kit (MD #306360). The kit contains a replacement display module programmed with the latest software available at the time of packaging.

This document explains how to install the display module provided in the kit.

NOTE: Keep your MacDon publications up-to-date. The most current version of this instruction can be downloaded from our Dealer-only site (<https://portal.macdon.com>) (login required).

NOTE: This instruction is available in English only.

Installation Time

Installation of this kit, including removal of the old HPT display module, installation of the new display module, and software updates (if needed) should take approximately 30 minutes.

Conventions

The following conventions are used in this document:

- Right and left are determined from the operator's position, facing forward with the windrower in cab-forward position.
- Unless otherwise noted, use the standard torque values provided in the windrower operator's manual and technical manual.

**M1 Series Windrower
Harvest Performance Tracker Display Kit (MD #306360)
INSTALLATION INSTRUCTIONS**

Parts List

A parts list is provided in this instruction so that you can confirm that you have received all required parts before you begin installation. This kit includes the following parts:

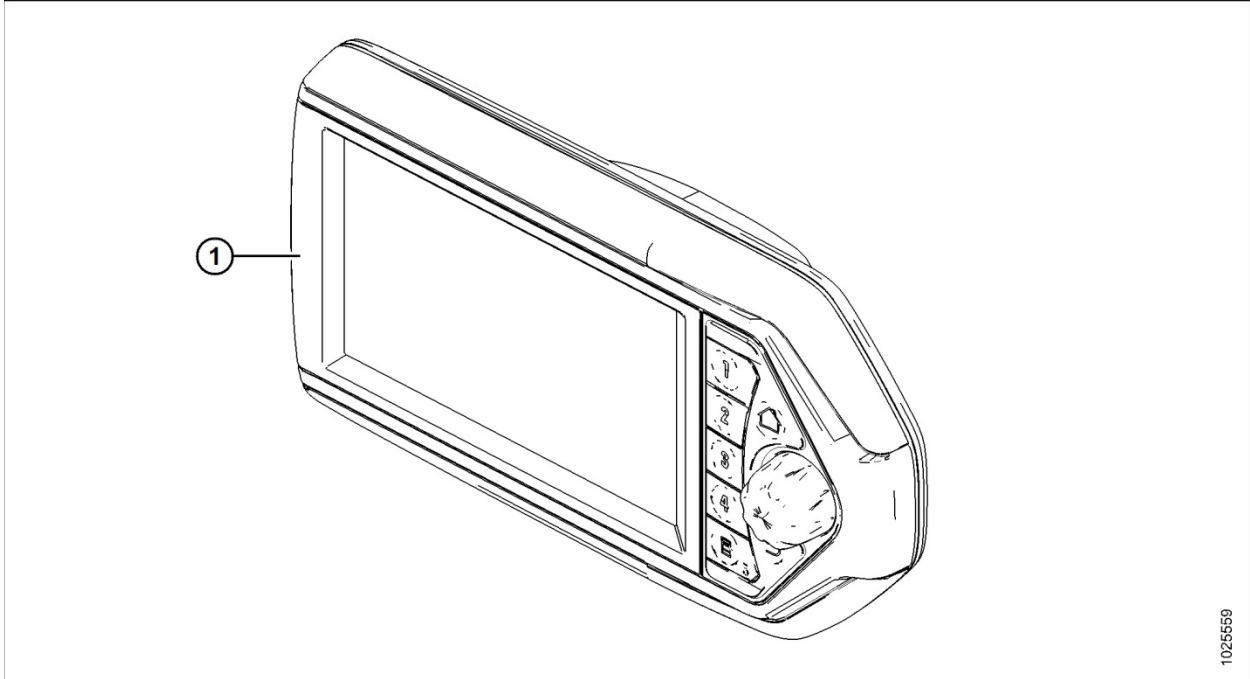

Ref	Part Number	Description	Quantity
1	NSS ¹	MODULE – CAB DISPLAY, BROWN	1
	NSS ¹	SOFTWARE – HPT DISPLAY (comes pre-installed on module)	1

¹ Not sold separately.

**M1 Series Windrower
Harvest Performance Tracker Display Kit (MD #306360)
INSTALLATION INSTRUCTIONS**

Installation Instructions

To install the Harvest Performance Tracker Display kit, follow these steps:

Installing the New Display



DANGER

To avoid bodily injury or death from unexpected start-up of machine, always stop engine and remove key from ignition before leaving operator's seat for any reason.

1. Shut down the engine, and remove the key from the ignition.
2. Open hood. For instructions, refer to the windrower operator's manual or technical manual.
3. Open the battery cover, and disconnect the negative battery terminals. For instructions, refer to the windrower technical manual.
4. Disconnect two plugs (P302 [black]) (A) and (P301 [white]) (B) on the back of the Harvest Performance Tracker (HPT) display module.

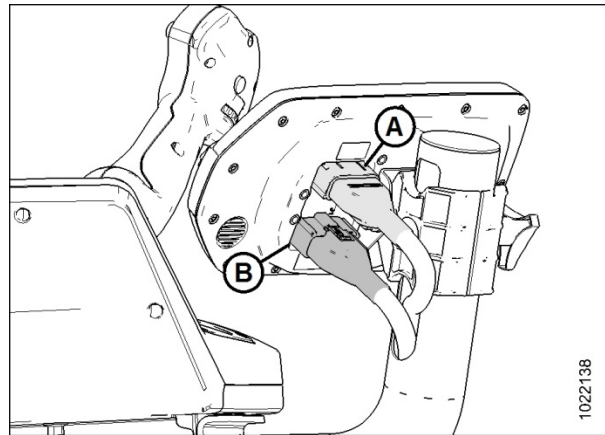

Figure 1: Connectors on Back of HPT Display

NOTE: To disconnect the plugs, slide red lock (A) rearward. Press down on tab (B) until it clears the retaining lock. Slide the connector rearward to remove.

NOTE: Pushing down tab (B) can be difficult, especially when both plugs are in place. You may need to use a screwdriver or other object to **CAREFULLY** apply pressure to the tab.

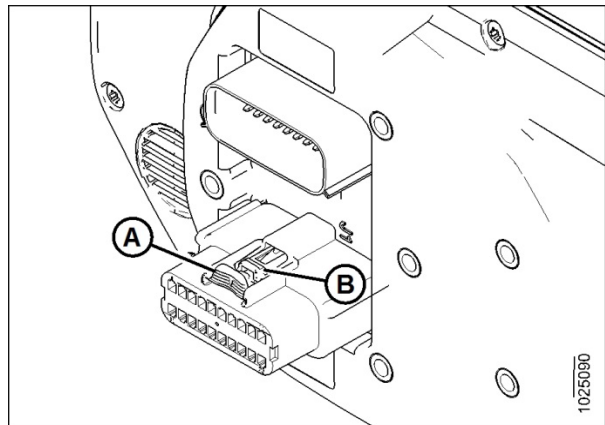

Figure 2: Display Connector on Back of HPT Display

M1 Series Windrower
Harvest Performance Tracker Display Kit (MD #306360)
INSTALLATION INSTRUCTIONS

5. Remove and retain hex head bolt (A), spring washer (B), and nut (C). Remove the display module.

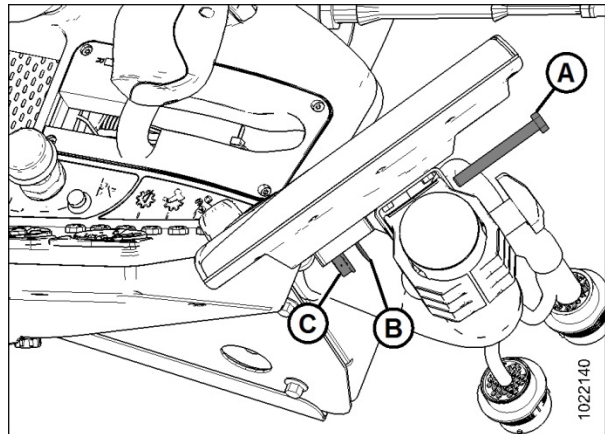

Figure 3: HPT Display Support Hardware – Side View

6. Remove and retain three bolts (A) from display support (B) and remove display (C).
7. Attach new display module (C) (provided in kit) to display support (B) using three bolts (A). Torque bolts to 3.1–3.6 Nm (27.4–31.9 lbf·in).

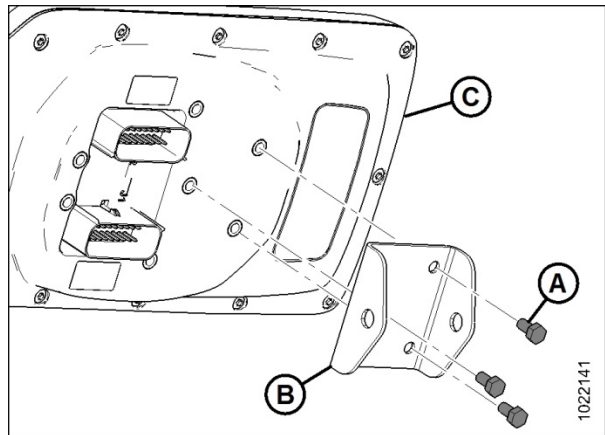

Figure 4: HPT Display and Support – Rear View

8. Mount the display module using retained hex head bolt (A), spring washer (B), and nut (C) from Step 5.

NOTE: Tighten the bolt so that the display module can be rotated by hand but remains stationary during normal operation.

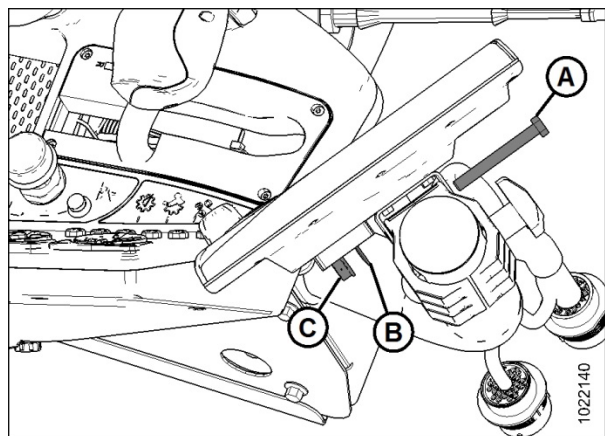

Figure 5: HPT Display Support Hardware – Side View

**M1 Series Windrower
Harvest Performance Tracker Display Kit (MD #306360)
INSTALLATION INSTRUCTIONS**

9. Connect two plugs (P302 [black]) (B) and (P301 [white]) (C) on the back of the HPT. Slide red lock tabs (A) to secure.
10. Reconnect the negative battery terminals, and then close the battery cover.
11. Close the hood.

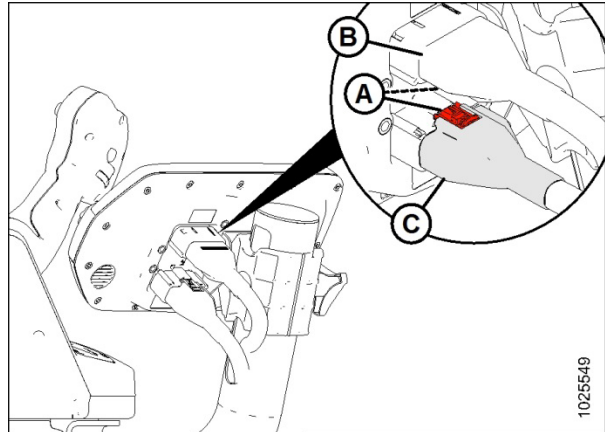

Figure 6: Connectors Reinstalled on Back of HPT Display

Updating the HPT Software

The new HPT display module comes programmed with the latest software available at the time of packaging. However, by the time you read this instruction, a newer software version may be available. The windrower master controller software may also require updating; the HPT software version must be matched to the windrower master controller software version.

The latest HPT and master controller software versions can be downloaded from our Dealer-only site (<https://portal.macdon.com>) (login required). Refer to the windrower technical manual for software downloading and installation instructions.

**M1 Series Windrower
Harvest Performance Tracker Display Kit (MD #306360)
INSTALLATION INSTRUCTIONS**

© 2023 MacDon Industries, Ltd.

The information in this publication is based on the information available and in effect at the time of printing. MacDon Industries, Ltd. makes no representation or warranty of any kind, whether expressed or implied, with respect to the information in this publication. MacDon Industries, Ltd. reserves the right to make changes at any time without notice.