

A40-D Auger Header
REEL SPEED KIT FOR M1 SERIES WINDROWERS (MD #291447)
INSTALLATION INSTRUCTIONS

Reel Speed kit (MD #291447) is required to make a MacDon A40-D or A40-D Grass Seed Special header from model year 2017 or later compatible with MacDon M1 Series Windrowers.

This document explains how to install the kit. A list of parts included in the kit is provided.

NOTE: Keep your MacDon publications up-to-date. The most current version of this instruction can be downloaded from our Dealer-only site (<https://portal.macdon.com>) (login required).

NOTE: This instruction is available in English.

Installation Time

Installation time for this kit is approximately 20 minutes.

Conventions

The following conventions are used in this document:

- Right and left are determined from the operator's position. The front of the header is the side that faces the crop; the back of the header is the side that connects to the windrower.
- Unless otherwise noted, use the standard torque values provided in the header operator's manual and technical manual.

**A40-D Auger Header
REEL SPEED KIT FOR M1 SERIES WINDROWERS (MD #291447)
INSTALLATION INSTRUCTIONS**

Parts List

This kit includes the following parts:

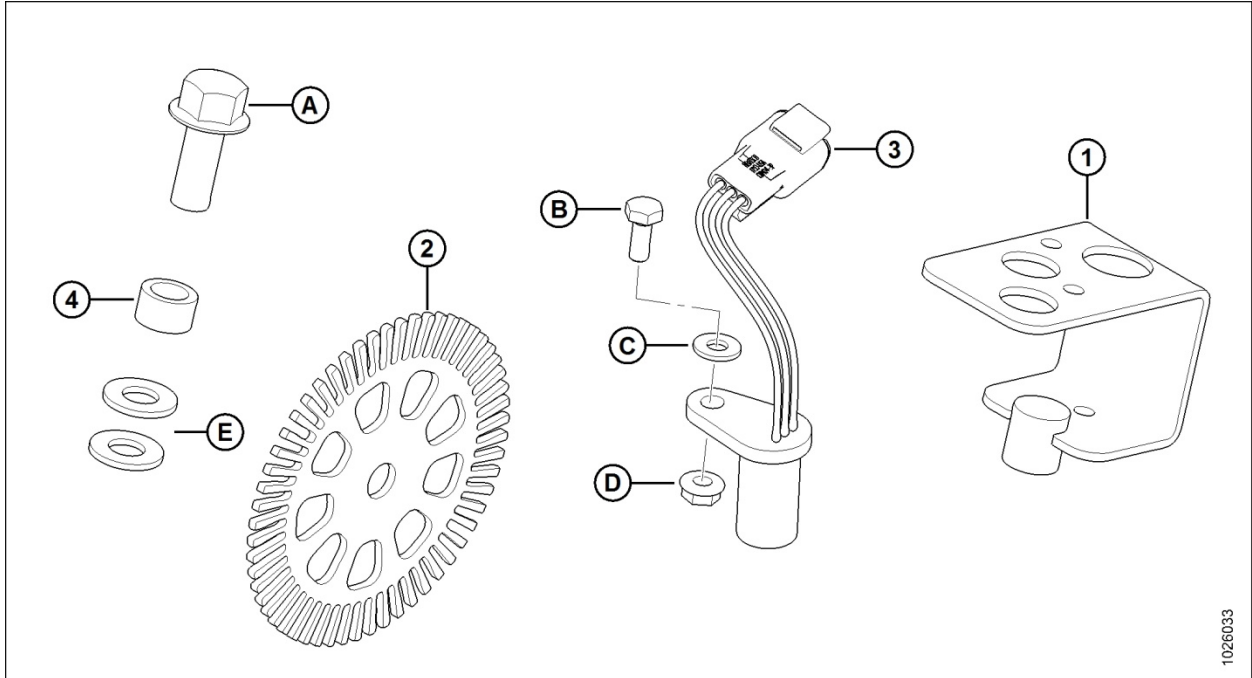

Ref	Part Number	Description	Quantity
1	209840	BRACKET – SPEED SENSOR	1
2	209854	PLATE – TRIGGER WHEEL	1
3	143875	SENDER – SPEED	1
4	157378	SPACER	1
A	135965	BOLT – HX HD FLG SM FACE ½ NC X 1.25 GR 5 ZN PL	1
B	21572	BOLT – HX HD ¼ NC X 0.625 LG FR 5 ZN PL	1
C	18596	WASHER – SAE FLAT 9/32 ID X 5/8 IN OD ZN PL	1
D	21455	NUT – FLG SERR FACE ¼ NC GR 5 ZN PL	1
E	18599	WASHER – SAE FLAT 17/32 ID X 1 1/16 IN OD AA1J	2

**A40-D Auger Header
REEL SPEED KIT FOR M1 SERIES WINDROWERS (MD #291447)
INSTALLATION INSTRUCTIONS**

Installation Instructions

To install the Reel Speed kit, follow these steps:

1. Open the left endshield by inserting screwdriver or equivalent into opening (A) at the base of endshield, and push to release latch.
2. Pull from the bottom and lift endshield until shield support (B) engages bolt. Check that support (B) is engaged before releasing hold on shield.

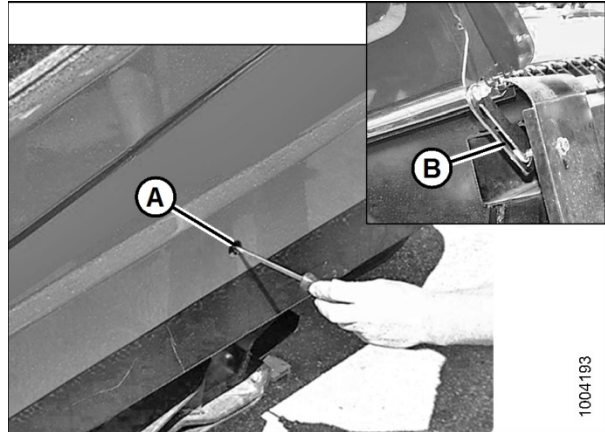

Figure 1: Left Driveshield

3. Locate speed sender (A), forward of the reel motor, and disconnect from header wiring harness.
4. Remove bolt, washers, and nut securing the speed sender (A) to the reel drive housing, and then remove the speed sender. Discard sender or keep it as a spare. Retain hardware for installation of new sender.

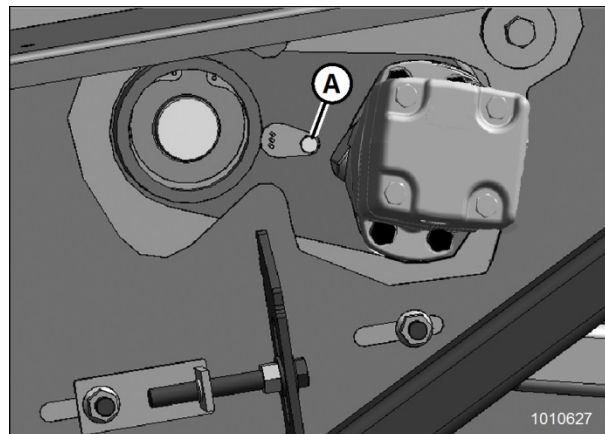

Figure 2: Left End of Header with Original Speed Sender

5. In place of the old speed sender, insert rod (A) on the new speed sensor bracket (B) (MD #209840) into the larger of the two holes forward of the reel motor. Secure bracket to the reel drive housing with hardware (C) retained from Step 4.

NOTE: Illustration is at an angle so that the relevant parts are visible. The side of the bracket with the open holes should be facing you. The motor was left out of the illustration for clarity.

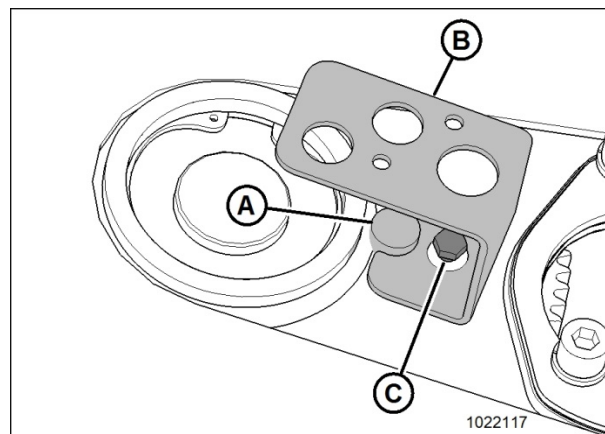

Figure 3: Speed Sensor Bracket Installed

**A40-D Auger Header
REEL SPEED KIT FOR M1 SERIES WINDROWERS (MD #291447)
INSTALLATION INSTRUCTIONS**

6. Insert 1.25 in. long hex head flange bolt (A) (MD #135965) through center of trigger wheel plate (B) (MD #209854), and then through spacer (C) (MD #157378).
7. Add 1 or 2 washers (D) (MD #18599) as needed to ensure gap between speed sender (shown in Figure 5) and trigger wheel plate (B) is 0.5–2.5 mm (1/64–3/32 in.).
8. Apply medium strength threadlocker (Loctite® 242 or equivalent) to bolt (A), and then use it to secure the trigger plate (B), spacer (C), and washers (D) to the end of the reel drive shaft. Torque bolt (A) to 113 Nm (83 lbf-ft).

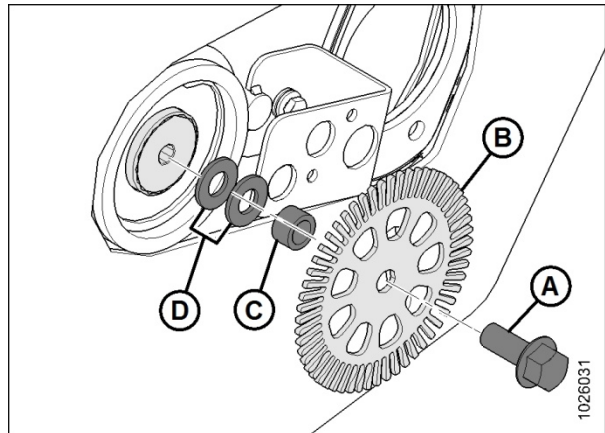

Figure 4: Installing Trigger Wheel Plate

NOTE: The edge of the trigger wheel plate fits inside the speed sensor bracket.

9. Secure the speed sender (A) (MD #143875) to the upper holes in the speed sensor bracket (B) with one hex head bolt (C) (MD #21572), one flat washer (D) (MD #18596), and one nut (MD #21455) as shown at right. The washer goes between the bolt head and the speed sender.

NOTE: If using the header with an M1 Series Windrower, move the speed sender to the bottom holes in the speed sensor bracket.

10. Plug connector P87 on the header wiring harness into the Deutsch receptacle (E) on the end of the speed sender.

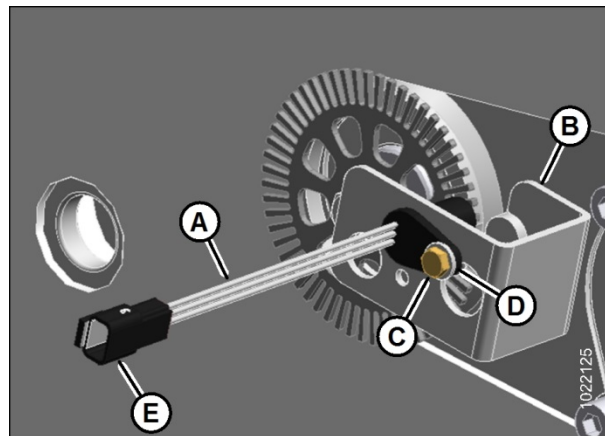

Figure 5: Speed Sender Installed

11. To close the left endshield, grasp top of endshield, push slightly, and move support inboard to disengage.
12. Lower endshield to about 300 mm (12 in.) from closed position.
13. Release endshield so that it drops to closed position. Ensure shield is latched.