

**D2 Series Draper and FD2 Series FlexDraper® Headers  
FLOATING CROP DIVIDER DEFLECTOR UPDATE KITS (MD #360939 and 360940)  
INSTALLATION INSTRUCTIONS**

The Deflector Update kits (MD #360939 and 360940) replace the superseded deflectors (MD #360095 and 360081) on floating crop dividers installed on D2 Series and FD2 Series Headers.

A list of parts included in the kit is provided.

**NOTE:** Keep your MacDon publications up-to-date. The most current version of this instruction can be downloaded from our Dealer-only site (<https://portal.macdon.com>) (login required).

**NOTE:** This document is currently available in English only.

**Conventions**

The following conventions are used in this document:

- Right and left are determined from the operator's position. The front of the header is the side that faces the crop; the back of the header is the side that connects to the combine or windrower.
- Unless otherwise noted, use the standard torque values provided in the header operator's manual and technical manual. When torque values of 30 Nm or less are listed, their equivalents will be provided in both foot-pounds (lbf·ft) and inch-pounds (lbf·in).

**D2 Series Draper and FD2 Series FlexDraper® Headers  
 FLOATING CROP DIVIDER DEFLECTOR UPDATE KITS (MD #360939 and 360940)  
 INSTALLATION INSTRUCTIONS**

**Parts List**

A parts list is provided in this instruction so that you can confirm that you have received all required parts before you begin installation.

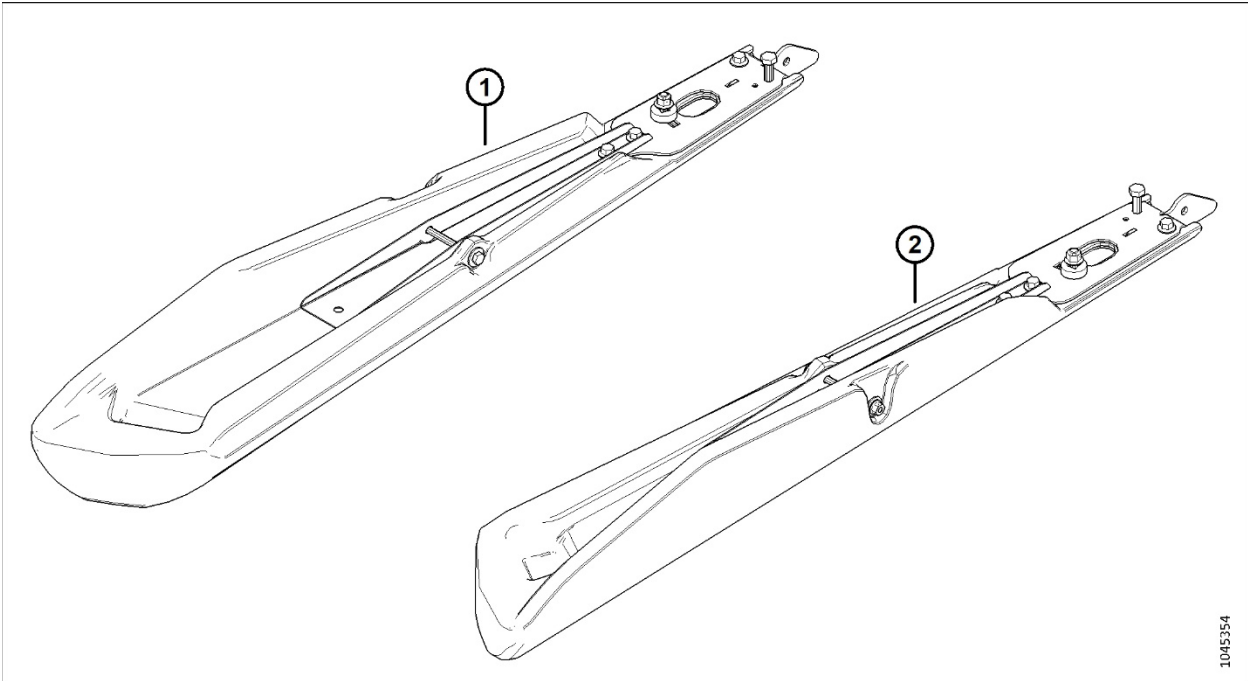

**Figure 1: Deflector Kits**

Ref	Part Number	Description	Quantity	
			MD #360939	MD #360940
1	NSS	LEFT DEFLECTOR ASSEMBLY	1	
2	NSS	RIGHT DEFLECTOR ASSEMBLY		1

**D2 Series Draper and FD2 Series FlexDraper® Headers  
FLOATING CROP DIVIDER DEFLECTOR UPDATE KITS (MD #360939 and 360940)  
INSTALLATION INSTRUCTIONS**

**Installation Instructions**

To install the Deflector Update kit, follow these steps:

**NOTE:** Throughout these instructions, when parts included in the kit are initially referenced, the part name is followed by its MacDon part number (MD #xxxxxx). If the part is not sold separately, the part name is followed by (MD #NSS). For more information, cross reference the part number to the parts list description and illustration.



**DANGER**

To prevent bodily injury or death from the unexpected start-up or fall of a raised machine, always stop the engine and remove the key from the ignition before making adjustments to the machine. NEVER climb onto or go underneath an unsupported header.

1. Ensure you are installing the new deflector on the correct divider assembly. Refer to **Figure 2** for a comparison.

- Left deflector kit (A) (MD #360939)
- Right deflector kit (B) (MD #360940)
- Left divider assembly (C)
- Right divider assembly (D)

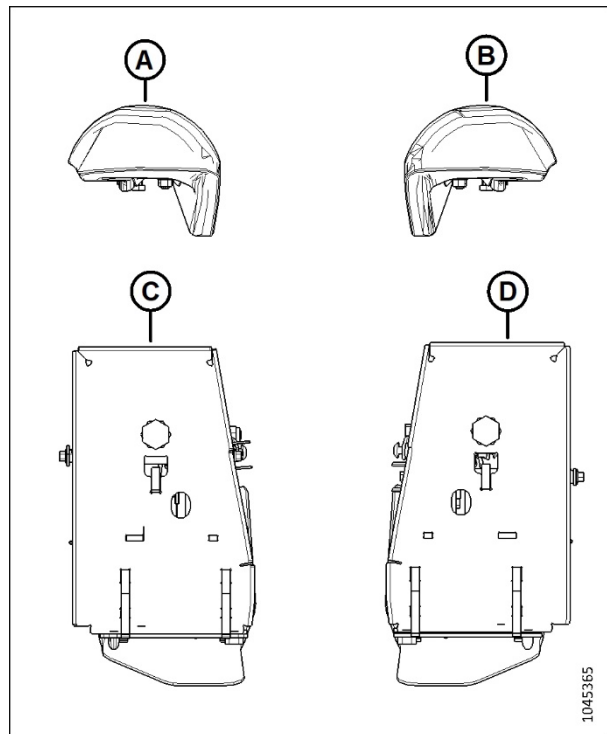
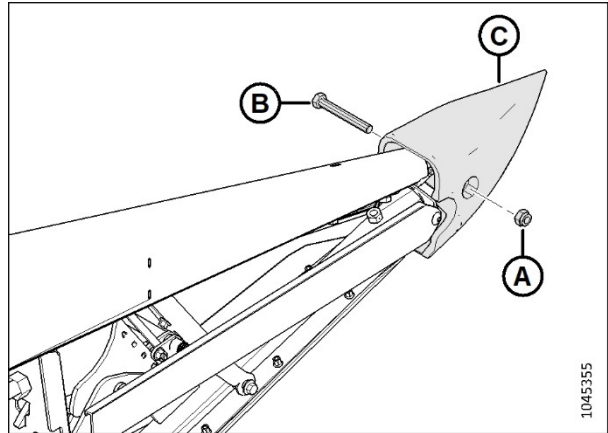

**Figure 2: Identifying Left and Right Assemblies – Viewed from Behind**

**D2 Series Draper and FD2 Series FlexDraper® Headers  
FLOATING CROP DIVIDER DEFLECTOR UPDATE KITS (MD #360939 and 360940)  
INSTALLATION INSTRUCTIONS**

**NOTE:** The illustrations in this instruction show the left deflector installation.

2. Remove and retain nut (A), bolt (B), and cone (C).



**Figure 3: Removing Cone**

3. Remove and retain hardware (A) that secures the front of deflector (C) to the divider.
4. Remove and discard hardware (B) that secures the deflector to support (D), and remove the deflector from the divider.

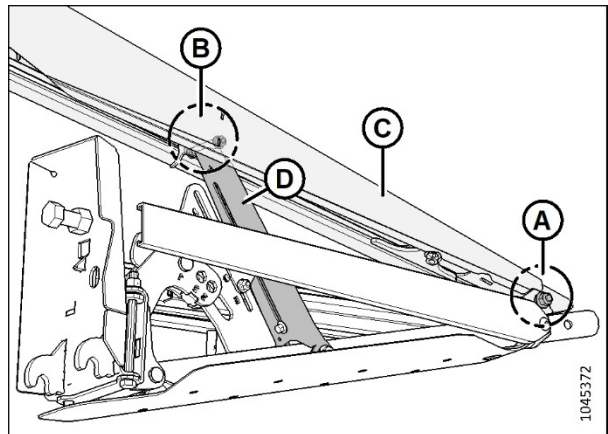

**Figure 4: Removing Deflector**

5. Remove nut (C) and bolt (D) that secure tube (A) to old deflector (B). Retain the tube and discard the deflector and hardware.

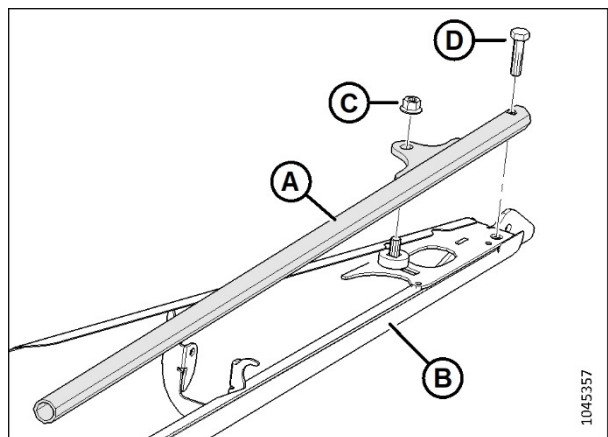

**Figure 5: Removing Tube**

**D2 Series Draper and FD2 Series FlexDraper® Headers**  
**FLOATING CROP DIVIDER DEFLECTOR UPDATE KITS (MD #360939 and 360940)**  
**INSTALLATION INSTRUCTIONS**

6. Install tube (A) onto new deflector assembly (B) using M10 center lock flange nut (C) and M10 x 45 mm hex bolt (D), which are preinstalled on the deflector. Ensure special washer (E) is in place between the tube and deflector.
7. Tighten nut (C) and bolt (D) to 39 Nm (29 lbf-ft).

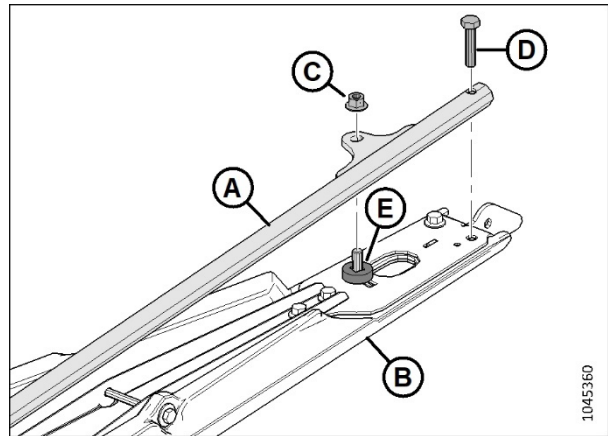

**Figure 6: Installing Tube onto New Deflector**

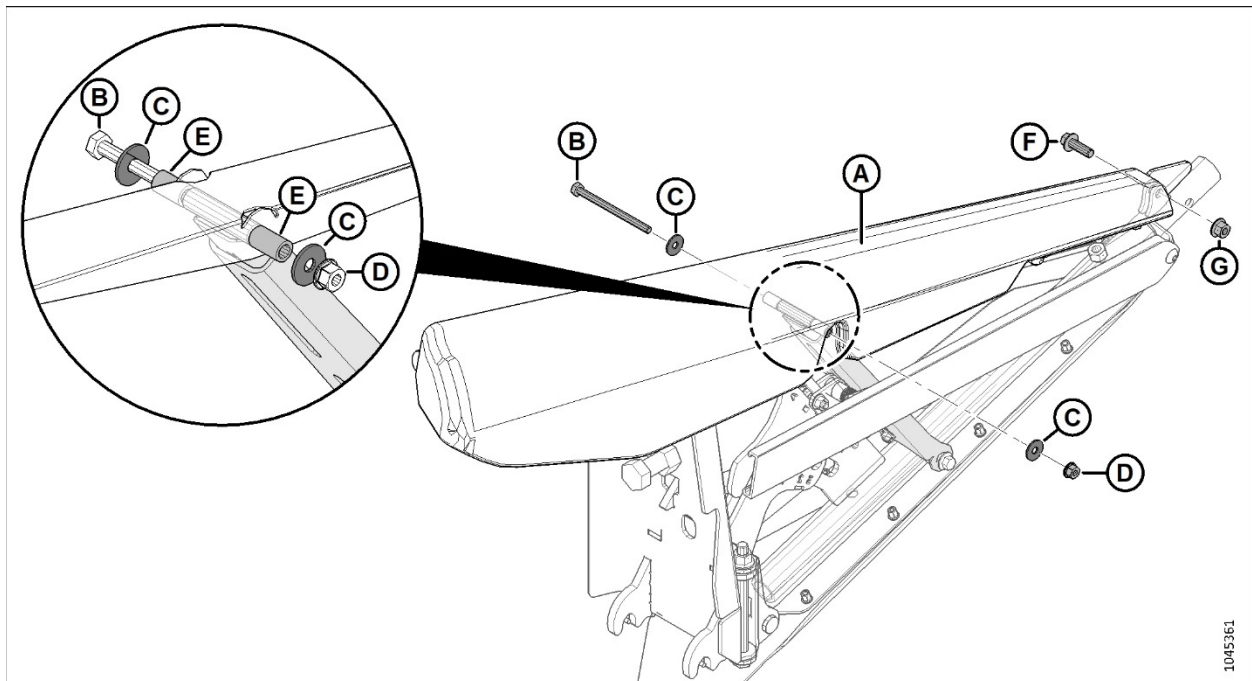
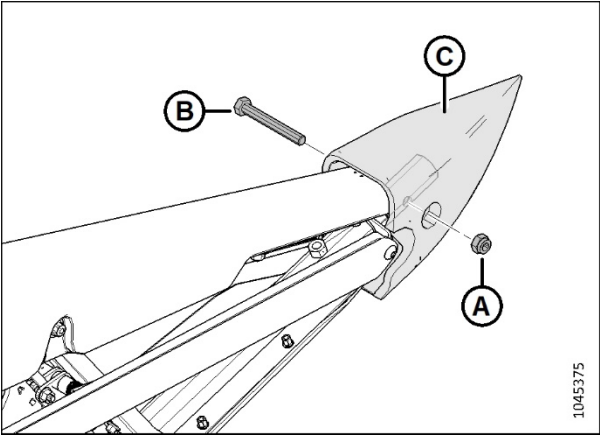

**Figure 7: Installing Deflector**

8. Install new deflector assembly (A) onto the deflector support using M8 x 110 mm bolt (B), two flat washers (C), and M8 center lock flange nut (D), which are preinstalled on the deflector.  
**NOTE:** When removing the hardware, keep spacer tubes (E) in place.
9. Attach the front of the deflector to the divider using retained M10 x 30 mm hex flange bolt (F) and center lock flange nut (G). Tighten nut (G) but ensure the front of the divider can still pivot on the bolt.
10. Tighten nut (D) to 23 Nm (17 lbf-ft [200 lbf-in]).

**D2 Series Draper and FD2 Series FlexDraper® Headers  
FLOATING CROP DIVIDER DEFLECTOR UPDATE KITS (MD #360939 and 360940)  
INSTALLATION INSTRUCTIONS**

- 11. Install cone (C) using retained M12 x 90 mm hex bolt (B) and Nyloc hex nut (A).



© 2024 MacDon Industries, Ltd.

The information in this publication is based on the information available and in effect at the time of printing. MacDon Industries, Ltd. makes no representation or warranty of any kind, whether expressed or implied, with respect to the information in this publication. MacDon Industries, Ltd. reserves the right to make changes at any time without notice.