

**FM100 Float Module**  
**GEAR PULLER TOOL (MD #304800)**  
**INSTRUCTIONS**

The Gear Puller Tool (MD #304800) is designed to assist Dealers with installing the Gearset 89/36 kit (B6191) or Gearset 97/28 kit (B6192) on the FM100 Float Module. This document explains how to use the tool.

A list of parts included in the kit is provided.

**NOTE:** Keep your MacDon publications up-to-date. The most current version of this instruction can be downloaded from our Dealer-only site (<https://portal.macdon.com>) (login required).

**NOTE:** This instruction is available in English only.

**Conventions**

The following conventions are used in this document:

- Right and left are determined from the operator's position. The front of the header is the side that faces the crop; the back of the header is the side that connects to the combine.
- Unless otherwise noted, use the standard torque values provided in the header operator's manual and technical manual.

**FM100 Float Module  
GEAR PULLER TOOL (MD #304800)  
INSTRUCTIONS**

**Parts List**

This kit includes the following parts:

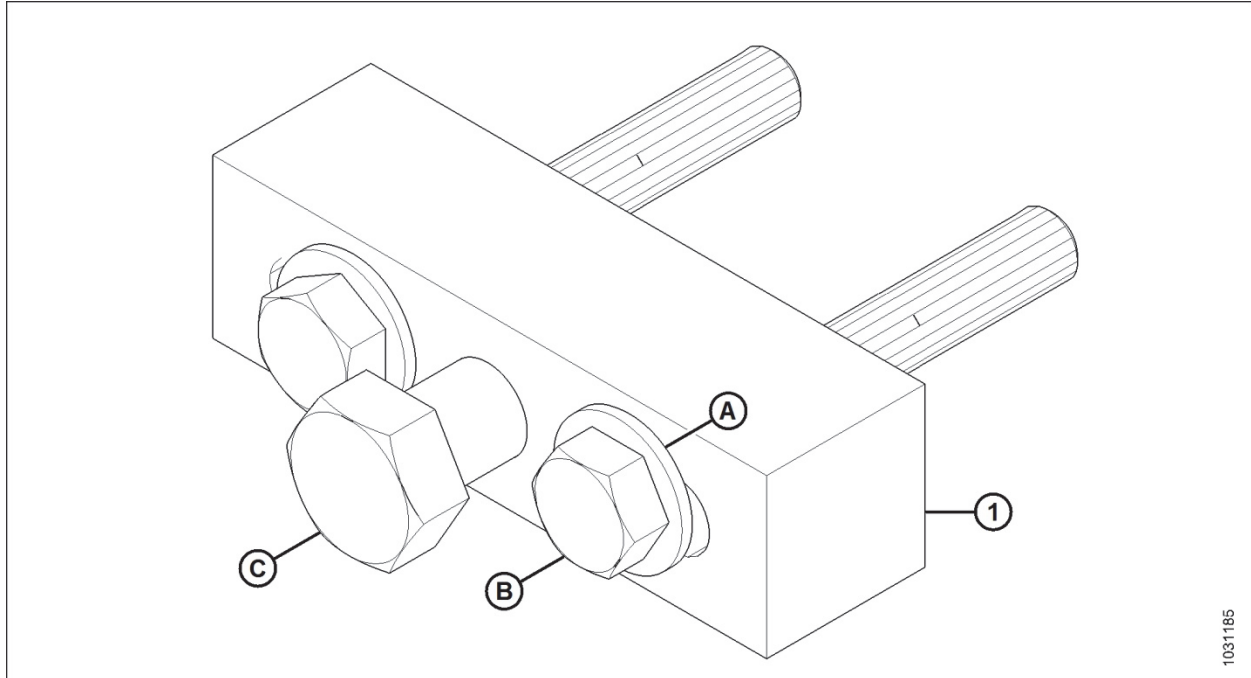

**Figure 1: Parts Included in Kit**

Ref	Part Number	Description	Quantity
1	NSS <sup>1</sup>	BAR	1
A	18598	WASHER – SAE FLAT 13/32 ID X 13/16 IN OD ZP	2
B	30035	BOLT – HEX HD 3/8-16 X2 .75 GR5-AA1J	2
C	50072	BOLT – HH 1/2 NC X 1.75 TFL GR 5 ZP	1

<sup>1</sup> Not sold separately

**FM100 Float Module  
GEAR PULLER TOOL (MD #304800)  
INSTRUCTIONS**

**Instructions**



**DANGER**

To avoid bodily injury or death from unexpected start-up or fall of raised machine, always stop engine, remove key, and engage safety props before going under header for any reason.

To use the Gear Puller Tool (MD #304800), follow these steps:

1. Remove cotter pin and castle nut from pump output shaft (D).
2. Line up outer bolts (A) on gear puller with holes in gear (B), and line up center 1/2 in. bolt (C) with output shaft (D).

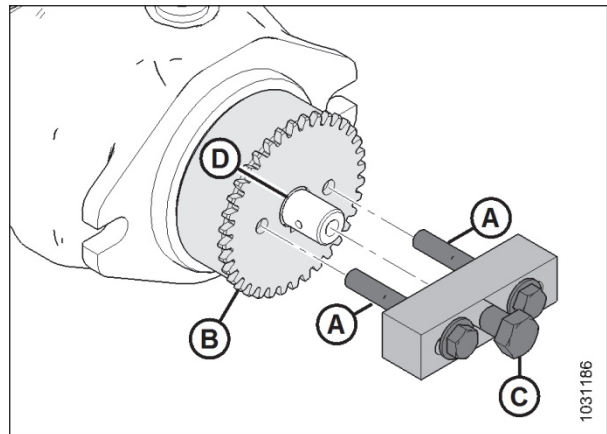

**Figure 2: Gear Puller Tool**

3. Hand-tighten outer bolts (A) on gear puller, making sure the bolts go completely through the gear.
4. Tighten center 1/2 in. bolt (B) to remove gear from shaft. If the gear does not loosen, give the center bolt a tap with a hammer.

**NOTE:** The key may or may not come off with the gear. Do **NOT** lose the key.

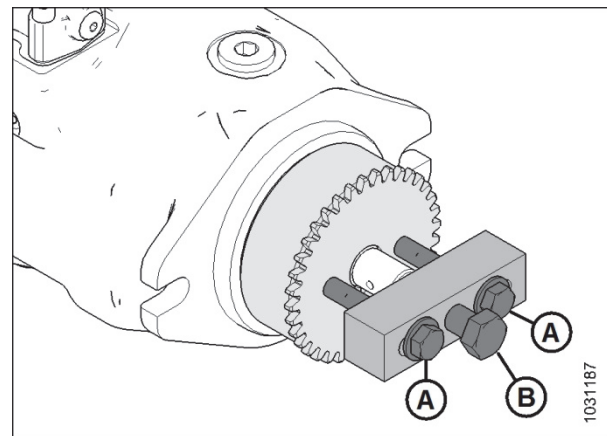

**Figure 3: Gear Puller Tool**

© 2019 MacDon Industries, Ltd.

The information in this publication is based on the information available and in effect at the time of printing. MacDon Industries, Ltd. makes no representation or warranty of any kind, whether expressed or implied, with respect to the information in this publication. MacDon Industries, Ltd. reserves the right to make changes at any time without notice.