

# FM100 Float Module PLASTIC COVER REPLACEMENT KIT (MD #301567) INSTALLATION INSTRUCTIONS

This document explains how to install the FM100 Plastic Cover Replacement kit (MD #301567). This kit is used to replace a damaged, original metal hydraulic cover.

A list of parts included in the kit is provided.

**NOTE:** Keep your MacDon publications up-to-date. The most current version of this instruction can be downloaded from our Dealer-only site (<https://portal.macdon.com>) (login required).

**NOTE:** This document is available in English.

## Installation Time

This kit takes approximately 15 minutes to install.

## Conventions

The following conventions are used in this document:

- Right and left are determined from the operator's position. The front of the header is the side that faces the crop; the back of the header is the side that connects to the combine.
- Unless otherwise noted, use the standard torque values provided in the FM100 operator's manual and technical manual.

**FM100 Float Module  
PLASTIC COVER REPLACEMENT KIT (MD #301567)  
INSTALLATION INSTRUCTIONS**

**Parts List**

This kit includes the following parts:

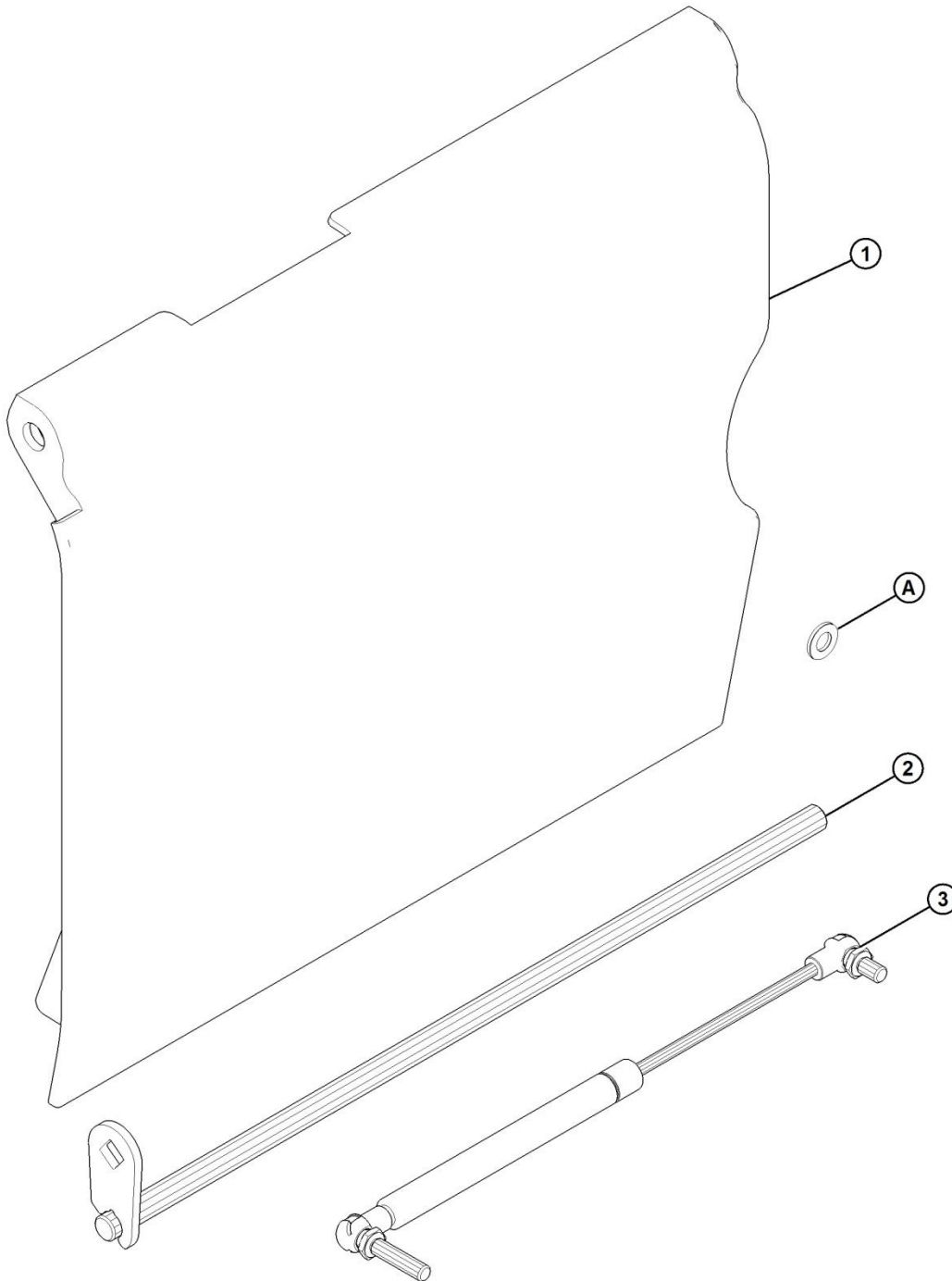

1025165

**FM100 Float Module  
PLASTIC COVER REPLACEMENT KIT (MD #301567)  
INSTALLATION INSTRUCTIONS**

<b>Ref</b>	<b>Part Number</b>	<b>Description</b>	<b>Qty</b>
1	287203	COVER – PLASTIC	1
2	287435	HINGE – WELDMENT	1
3	295981	GAS SPRING	1
A	184708	WASHER – FLAT M8-200HV-AA1J	7

**FM100 Float Module  
PLASTIC COVER REPLACEMENT KIT (MD #301567)  
INSTALLATION INSTRUCTIONS**

**Installation Instructions**

To replace the hydraulic cover on an FM100 Float Module, follow these procedures:

**Removing Metal Cover**

To remove the metal cover from the FM100, use the following procedure:



**CAUTION**

**To avoid bodily injury or death from unexpected startup of machine, always stop engine and remove key from ignition before leaving operator's seat for any reason.**

1. Stop engine, and remove key from ignition.
2. Open cover (A).
3. Remove lower nut (B) from gas spring. Retain hardware for reinstallation.
4. Remove upper nut (C) from cover (A). Retain hardware for reinstallation.
5. Discard gas spring.

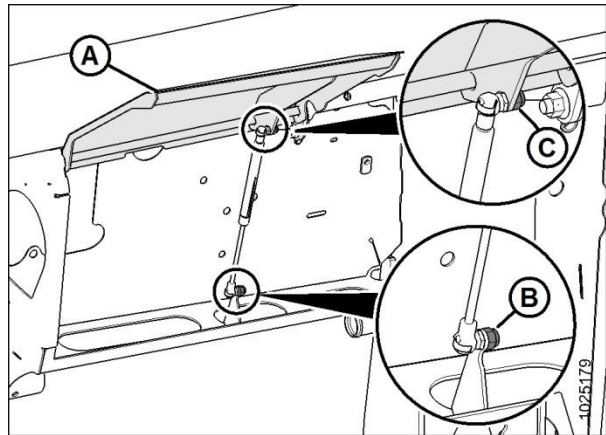

Figure 1: Hydraulic Cover

6. Remove nut and bolt (A) from cover retainer (B) and remove retainer. Retain hardware for reinstallation.

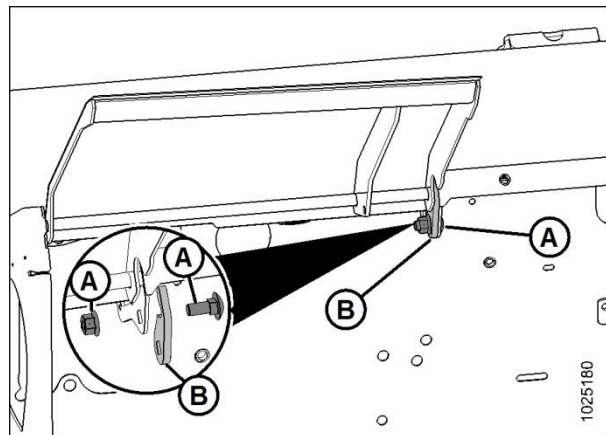

Figure 2: Hydraulic Cover

**FM100 Float Module**  
**PLASTIC COVER REPLACEMENT KIT (MD #301567)**  
**INSTALLATION INSTRUCTIONS**

- Slide pivot (A) to right and remove cover (B). Discard pivot and cover.

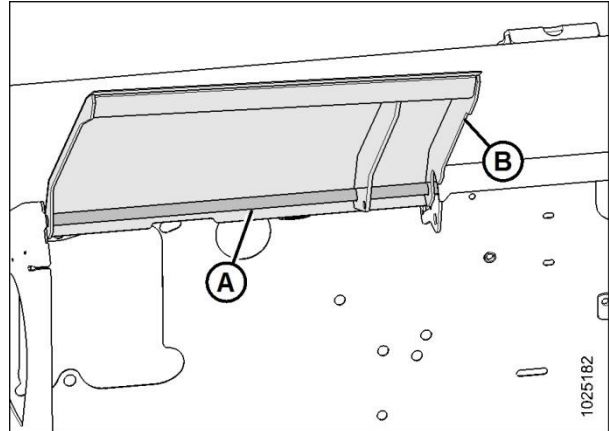

Figure 3: Hydraulic Cover

**Installing Plastic Cover**

To install the plastic replacement cover (MD #287203) on an FM100, use the following procedure:

- Slide hinge (C) (MD# 287435) through cover (A) (MD #287203).
- Place cover (A) between metal tabs (B) on frame.
- Install hinge in position using retained bolt and nut (D).

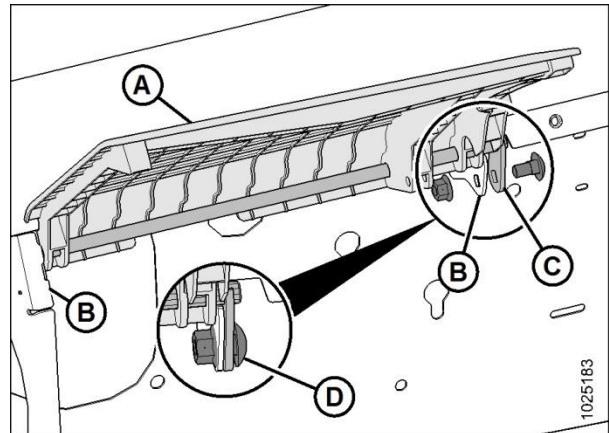

Figure 4: Plastic Hydraulic Cover

- Install cylinder end of gas spring (A) (MD # 295981) on cover at location (B) using retained nut. Install washers (D) (MD #184708) between plastic tabs to fill gap as required. Torque nut (C) to 8–9 Nm (70–85 lbf·in.).

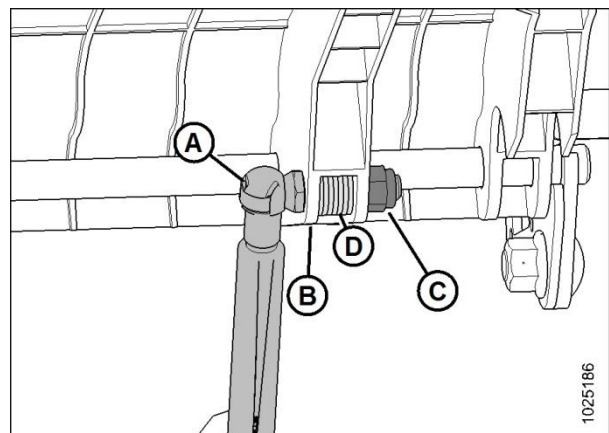

Figure 5: Gas Spring and Washers

**FM100 Float Module  
PLASTIC COVER REPLACEMENT KIT (MD #301567)  
INSTALLATION INSTRUCTIONS**

5. Install rod end of gas spring at location (A) using retained hardware (B).
6. Close cover.

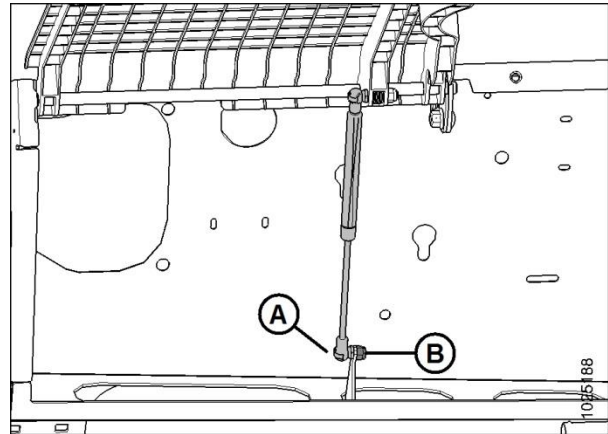

Figure 6: Gas Spring and Cover