

**R1 Pull-Type Disc Mower  
DRIVELINE GUARD STABILIZER KIT (MD #281715)  
INSTALLATION INSTRUCTIONS**

The Driveline Guard Stabilizer kit (MD #281715) is used to replace stabilizer (A) on the hitch driveline. Before installing the new stabilizer, it is important to condition it properly to avoid cracking during installation. This instruction shows how to condition and install the new stabilizer.

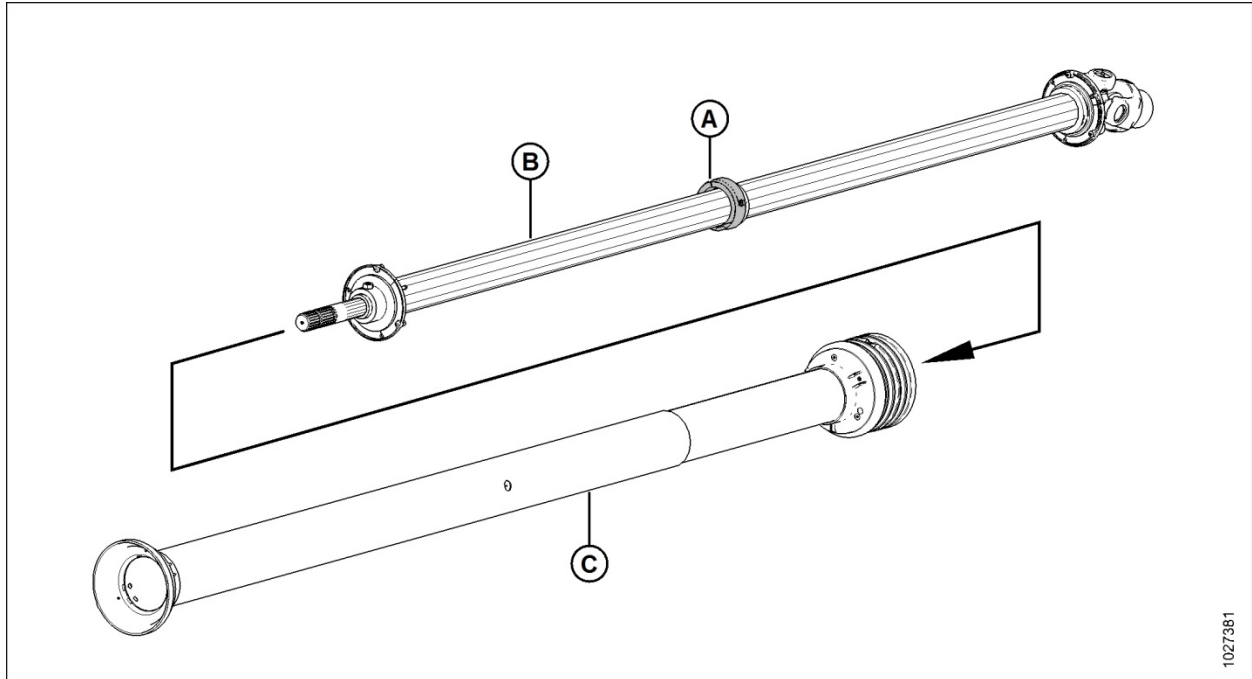

**Figure 1: Hitch Driveline**

**A - Stabilizer**

**B - Driveshaft**

**C - Driveline Shields**

**NOTE:** Keep your MacDon publications up-to-date. The most current version of this instruction can be downloaded from our Dealer-only site (<https://portal.macdon.com>) (login required).

**NOTE:** This document is currently available in English only.

**Conventions**

The following conventions are used in this document:

- Right and left are determined from the operator's position. The front of the disc mower is the side that faces the crop.
- Unless otherwise noted, use the standard torque values provided in the disc mower operator's manual and technical manual.

**R1 Pull-Type Disc Mower  
DRIVELINE GUARD STABILIZER KIT (MD #281715)  
INSTALLATION INSTRUCTIONS**

**Installation Instructions**



**CAUTION**

To avoid bodily injury or death from unexpected startup of machine, always stop engine and remove key from ignition before leaving operator's seat for any reason.

To install the new stabilizer, follow these steps:

1. Place new stabilizer (A) in a pot of tap water with a minimum temperature of 49°C (120°F), and let stabilizer soak for 15 minutes.

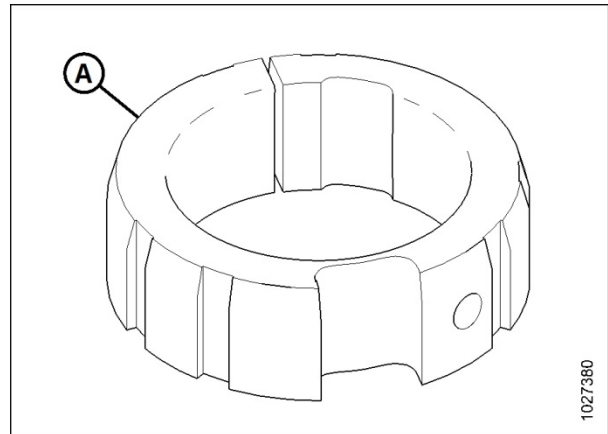

**Figure 2: Driveline Guard Stabilizer**

2. Remove new stabilizer (A) from the hot water.
3. Carefully position the stabilizer on the driveshaft, with the chamfer on the shaft end.  
**IMPORTANT:** Be careful when spreading new stabilizer open during installation. Overstressing it can cause it to break.
4. Line up the hole in the stabilizer with the hole in the driveshaft.
5. Secure the stabilizer in place with one M4 x 12 screw (B).

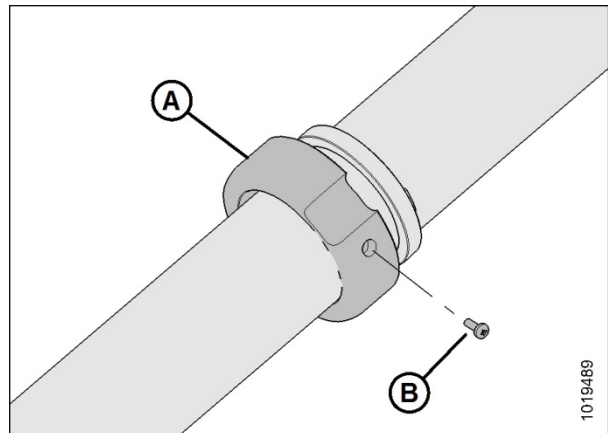

**Figure 3: Stabilizer on Driveshaft**