

**D1 Series Draper Headers
SHORT BRACE KIT (MD #255845 and B6401)
INSTALLATION INSTRUCTIONS**

The Short Brace kit (MD #255845 and B6401¹) is required on all MacDon D1 Series single-reel headers that will be operated with the reel in the rearmost position (often used when harvesting canola). The kit is factory-installed on D125 units sold in Europe.

A list of parts included in the kit is provided.

NOTE: This instruction is available in English only.

Installation Time

Installation time for this kit is approximately one hour.

Conventions

The following conventions are followed in this document:

- Right and left are determined from the operator’s position. The front of the header is the side that faces the crop; the back of the header is the side that connects to the combine.
- Unless otherwise noted, use the standard torque values provided in the header operator’s manual and technical manual.

Table of Contents

Installation Time	1
Conventions	1
Part List	2
Installation Instructions.....	3
Installing Left Brace	3
Installing Right Brace	5
Centering Reel.....	6

¹ MD #255845 is available from MacDon Parts while MD #B6401 is available from Whole Goods only. They contain the same parts.

**D1 Series Draper Headers
SHORT BRACE KIT (MD #255845 and B6401)
INSTALLATION INSTRUCTIONS**

Parts List

This kit includes the following parts:

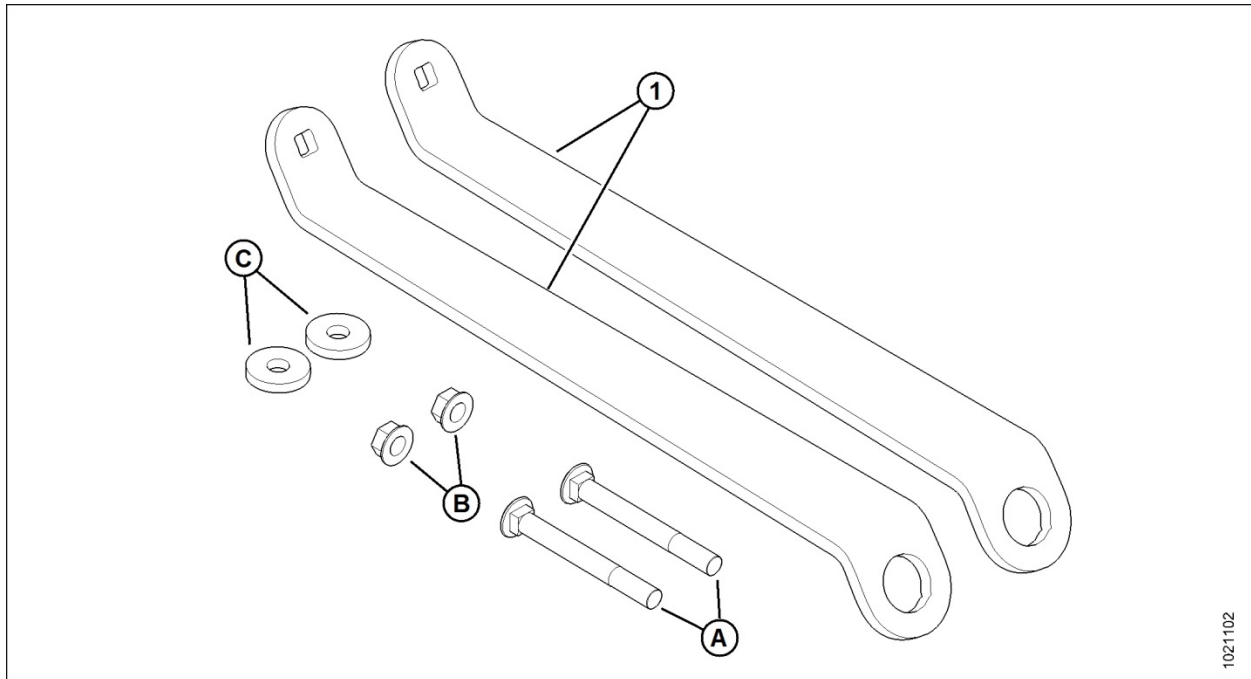

1021102

Ref	Part Number	Description	Quantity
1	255831	BRACE – DIAGONAL, SHORT	2
A	129847	BOLT – RHSN 1/2 NC X 4.5 LG GR 5 ZP	2
B	50186	NUT – FLANGE LOCK SM FACE DT 0.500-13UNC GR5	2
C	18770	WASHER – FLAT	2

D1 Series Draper Headers SHORT BRACE KIT (MD #255845 and B6401) INSTALLATION INSTRUCTIONS

Installation Instructions

To install the Short Brace kit, follow these steps:

Installing Left Brace

1. On the left end of the header back tube, remove hardware (A) securing the existing diagonal brace (B) to the diagonal brace support (C). Retain hardware for installation of the new brace.
2. Remove hardware (D) securing the other end of the diagonal brace (B) to the reel support arm. Discard bolt and nut, but retain spacer tube.
3. Remove parts from kit.

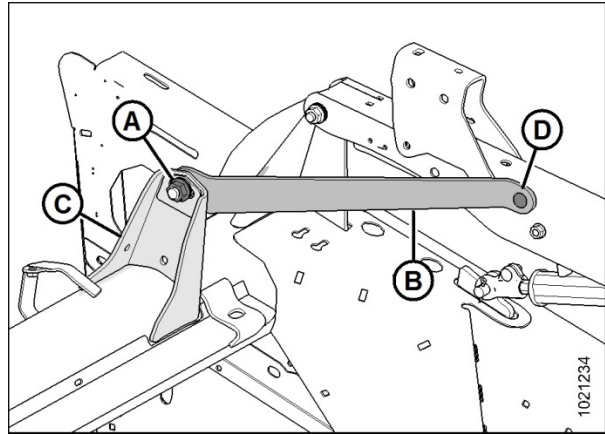

Figure 1: Existing Left Diagonal Brace

4. Loosely attach one end of the new short diagonal brace (C) (MD #255831) to the diagonal brace support (E) on the left end of the header back tube using the hardware retained from Step 1. For the order in which the hardware should be assembled, refer to the illustration at right.

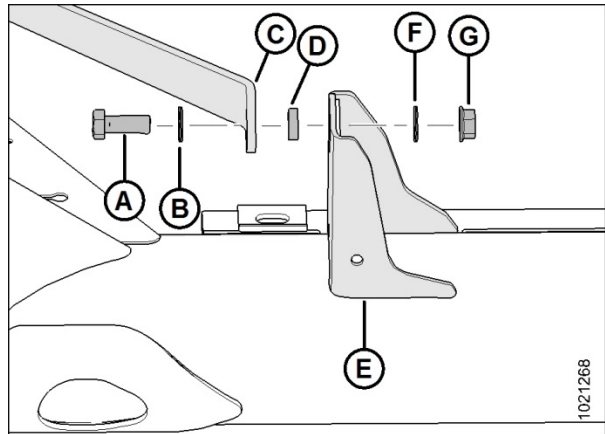

Figure 2: Securing Left Brace to Diagonal Brace Support – View from Behind Header

A – Bolt
B – Washer
C – Short Diagonal Brace
D – Spacer
E – Diagonal Brace Support
F – Washer
G – Nut

D1 Series Draper Headers SHORT BRACE KIT (MD #255845 and B6401) INSTALLATION INSTRUCTIONS

- On the reel support arm, attach the other end of the new short diagonal brace (A) to the existing hole at the bottom front of the tail support bracket (B) with one carriage bolt (C) (MD #129847), the spacer tube retained from Step 2, and one flange lock nut (MD #50186).

To see where to attach the brace to the reel support arm, refer to Figure 3.

To see the order in which the parts go together, refer to Figure 4.

NOTE: On North American units, attach the brace directly to the reel support arm in the same location; there is no tail support bracket on these units.

- Torque to 106–118 Nm (79–87 lbf-ft).

NOTE: To make the order of parts clear, the right reel support arm is illustrated as if it were transparent in the figure at right.

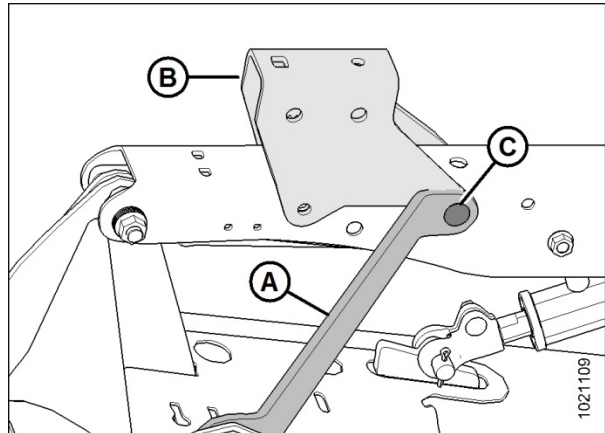

Figure 3: Left Brace Secured to Reel Support Arm

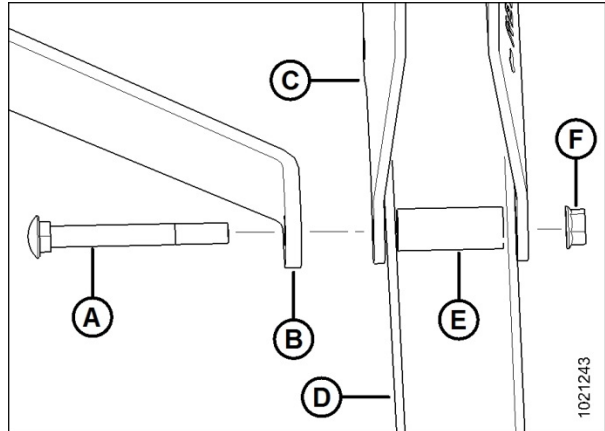

Figure 4: Connecting Left Brace to Left Reel Support Arm

A – Carriage Bolt	B – Short Diagonal Brace
C – Tail Support Bracket	D – Reel Support Arm
E – Spacer Tube	F – Flange Lock Nut

D1 Series Draper Headers SHORT BRACE KIT (MD #255845 and B6401) INSTALLATION INSTRUCTIONS

Installing Right Brace

1. On the right end of the header back tube, remove hardware (A) securing the existing diagonal brace (B) to the diagonal brace support (C). Retain hardware for installation of the new brace.
2. Remove hardware (D) securing the other end of the diagonal brace (B) to the reel support arm. Discard bolt and nut, but retain spacer tube.

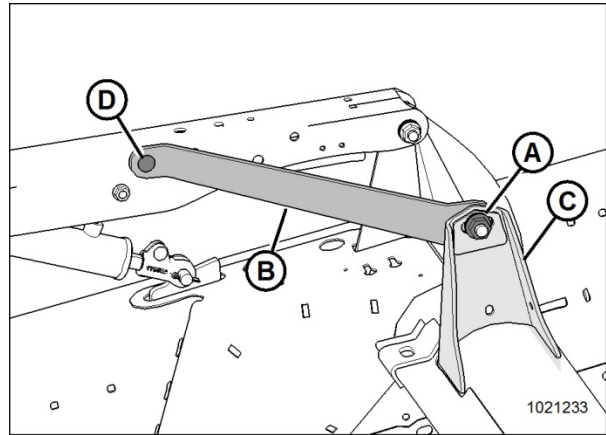

Figure 5: Existing Right Diagonal Brace

3. Loosely attach one end of the new short diagonal brace (E) (MD #255831) to the diagonal brace support (C) on the right end of the header back tube with the hardware retained from Step 1. For the order in which the hardware should be assembled, refer to the illustration at right.

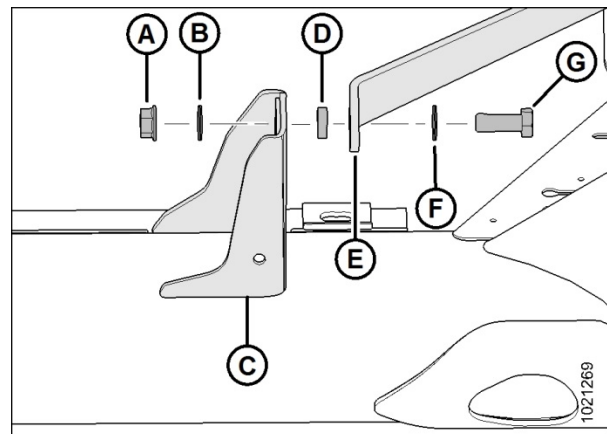

Figure 6: Securing right Brace to Diagonal Brace Support – View from Behind Header

A – Nut	B – Washer
C – Diagonal Brace Support	D – Spacer
E – Short Diagonal Brace	F – Washer
G – Bolt	

D1 Series Draper Headers SHORT BRACE KIT (MD #255845 and B6401) INSTALLATION INSTRUCTIONS

- Attach the other end of the new short diagonal brace (A) to the existing holes on the reel support arm with one carriage bolt (B) (MD #129847), two flat washers (MD #18770), the spacer tube retained from Step 2, and one flange lock nut (MD #50186).

To see where to attach the brace to the reel support arm, refer to Figure 7.

To see the order in which the parts go together, refer to Figure 8.

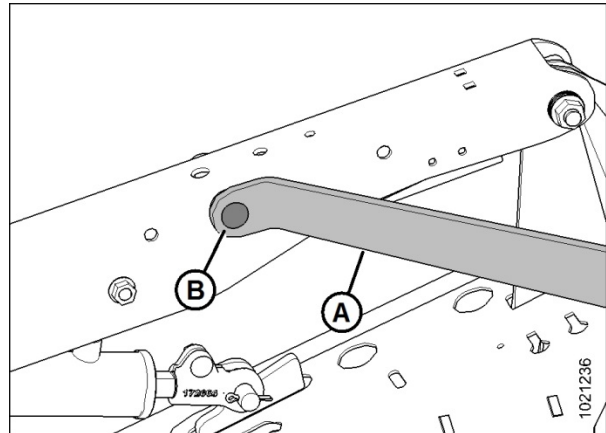

Figure 7: Right Brace Secured to Reel Support Arm

- Torque to 106–118 Nm (79–87 lbf-ft).

NOTE: To make the order of parts clear, the right reel support arm is illustrated as if it were transparent in the figure at right.

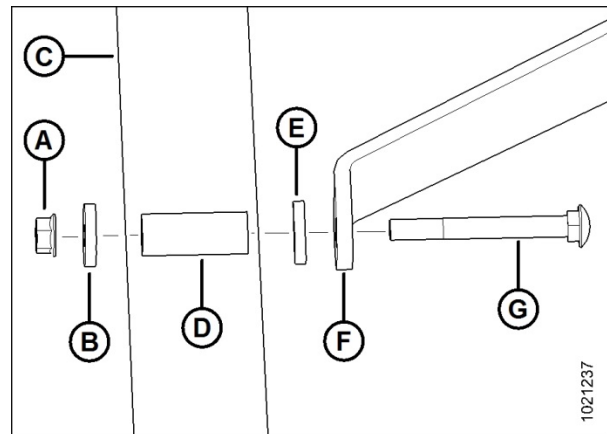

Figure 8: Connecting Right Brace to Right Reel Support Arm

A – Flange Lock Nut	B – Flat Washer
C – Reel Support Arm	D – Spacer Tube
E – Flat Washer	F – Short Diagonal Brace
G – Carriage Bolt	

Centering Reel

- With bolt (A) loose, move the forward end of the reel support arm (B) laterally as required to center the reel between the header end shields.
- Tighten bolts (A) and torque to 359 Nm (265 lbf-ft).

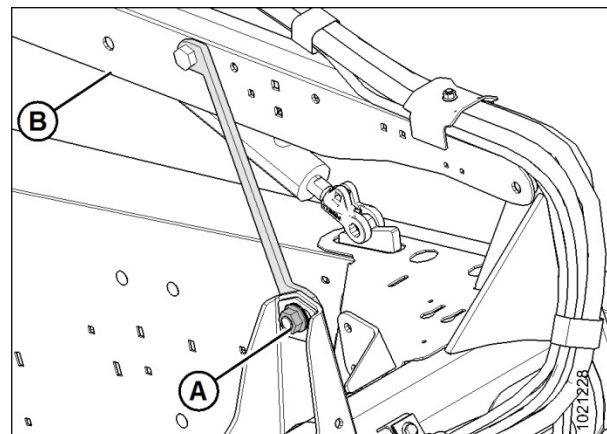

Figure 9: Diagonal Brace on Right Reel Arm