

MacDon Model 5020 / Frontier MC1200 Series TOP ROLL STABILIZER KIT INSTALLATION INSTRUCTIONS

1. Position L/H roll arm stop (A) between frame panel and roll arm as shown.
NOTE: Place 5 mm fillet welds in locations shown.

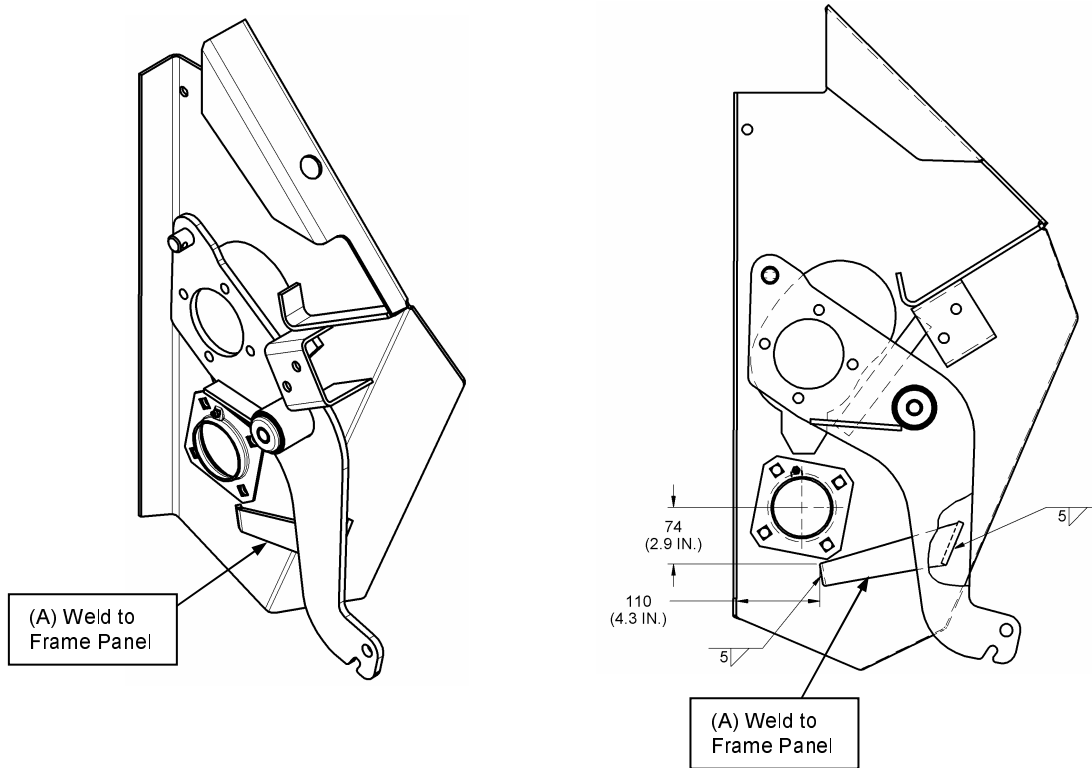

2. Position front R/H roll arm stop (B) and rear R/H roll arm stop (C) between frame panel and roll arm as shown.
NOTE: Place 5 mm fillet welds in locations shown.

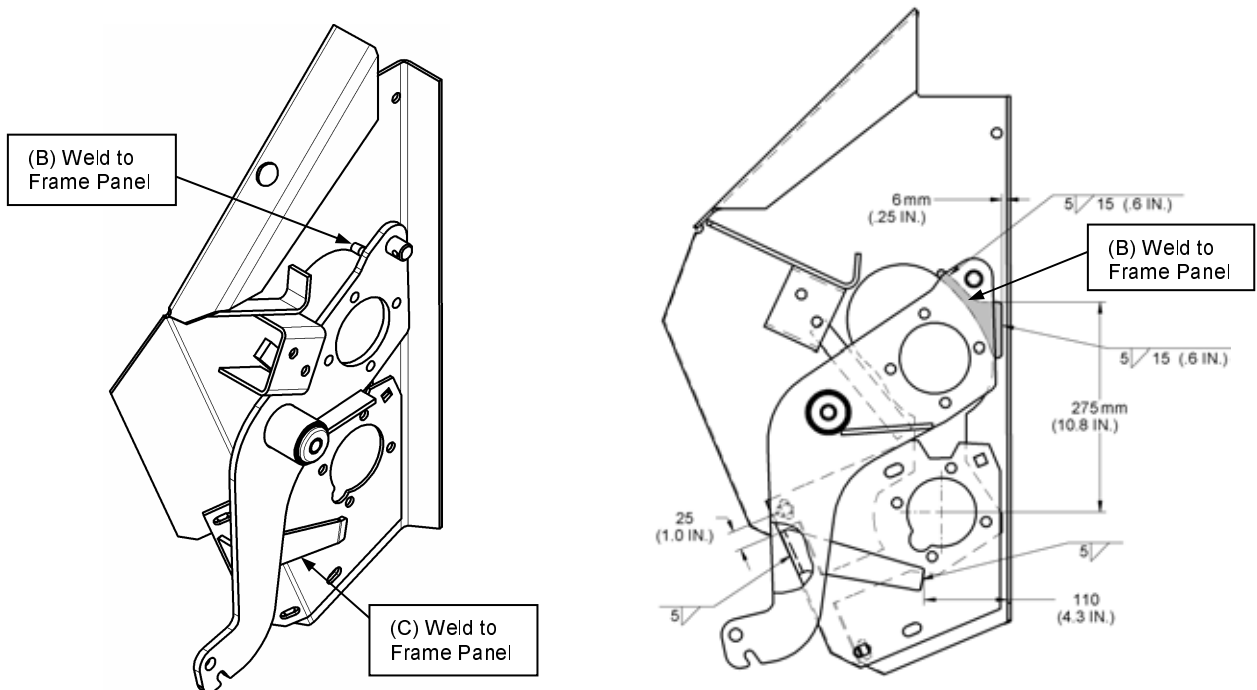

**MacDon Model 5020 / Frontier MC1200 Series
TOP ROLL STABILIZER KIT
INSTALLATION INSTRUCTIONS**

3. Install rubber washer (D) at top roll adjuster rod (both sides of header) as shown.

