

MacDon® *The Harvesting Specialists.*



Performance Options

D2 Draper, FD2 FlexDraper®, and FD2 PLUS FlexDraper® for Combine

2-Series Performance Options

Get ready for even more!

More Capacity. More Speed. More Flex. The all-new D2 and FD2 headers give you more of everything you need for harvesting performance from the company that brought you the Original FlexDraper®. These amazing performance options have been specifically designed to work with the benefits of the D2 and FD2 to get you even more harvesting performance.

Any crop. Any condition. Every harvest.

MacDon Performance Options take your 2 Series headers to the next level.



TABLE OF CONTENTS

Knife Guard Configuration	3
Spare Knife	4
EasyMove™ Slow Speed Transport	5
ContourMax™ Contour Wheels	6
Stabilizer Wheels	7
Full Length Upper Cross Auger	8
Vertiblade™ Vertical Knives	9
Hydraulic Reservoir Fill Extension	10
Rock Retarder Kit	11
High Wear Skid Shoes	12
Lateral Tilt Module	13
Floating Crop Dividers	14
Rice Divider Rods	15
Crop Divider Storage Bracket	16
Crop Lifter Kit and Storage Rack	17
Extended Center Filler	18
Full Interface Filler FD2	19
Stubble Light Kit	20
Side-Hill Stabilizer	21
Tine Tube / Reel Conversion Kits	22
Header Tilt Footswitch	23
Dual Speed Reel Drive	24
2-Series Sunflower Attachment	25
FM200 Feeding Performance Configurations	26

Knife Guard Configuration



LEGEND



GOOD

BETTER

BEST

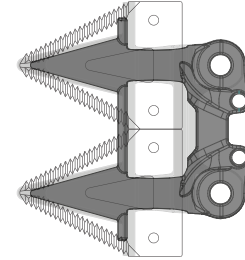
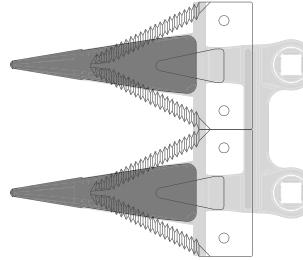

Knife Guard Configuration

	2-Series Pointed Guards	2-Series PlugFree Guards
Factory Ordered Configuration	Yes	Yes
Ordered From Parts	Yes	Yes
Cut Quality in Thin Crop	BETTER	GOOD
Cut Quality in Average Crop	BETTER	BETTER
Cut Quality in Heavy Downed/Double Crop	BETTER	BEST
Cut Height	GOOD	BEST
Rock Resistance to Guard Breakage	BETTER	BEST
Rock Resistance to Sickle Breakage	BETTER	GOOD
Resistance to Flagging	BETTER	GOOD
Resistance to Plugging (Mouse Nesting)	GOOD	BEST
Performance in Cereals	BETTER	BETTER
Performance in Soybeans	BETTER	BETTER
Performance in Pulse Crops	BETTER	BETTER
Performance in Oil Seeds	GOOD	BETTER
Performance in Rice	GOOD	BEST
Performance in Forage	GOOD	BETTER
Performance in Alfalfa	BETTER	BETTER
Performance in Grass Seed	GOOD	BEST
Maintenance & Adjustment	BETTER	GOOD
Cutting Speed on Combine	BETTER	BETTER
Cutting Speed on Windrower	BEST	BEST
Factory Configured Cost	BEST	GOOD
Cost of Ownership in Average Conditions	BETTER	BEST
Install Time	BETTER	GOOD

Spare Knife

MacDon

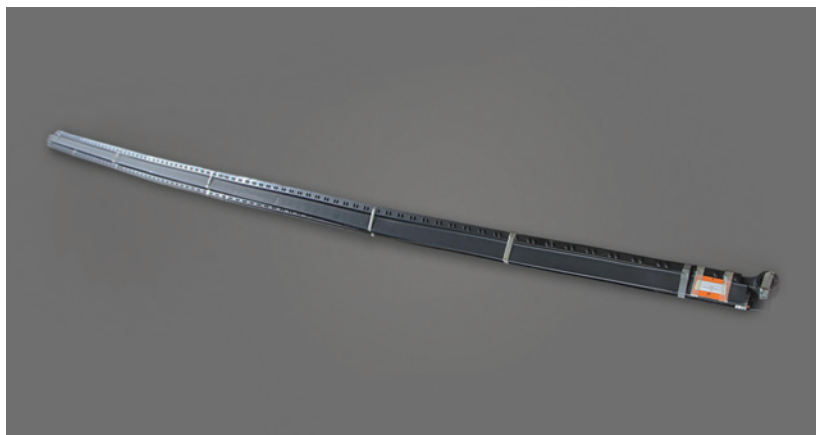

WHAT IT DOES

This kit is used to replace a damaged knife while in the field with a full length factory replacement. The spare knife is installed at the factory into the backtube of the header before shipping. Never be without a spare knife in the field.

FEATURES/BENEFITS

- » The spare knife is stored out of the way inside the backtube of D2 and FD2 Series headers

Notes:

Only available when ordered and shipped with header.

IDEAL CROP CONDITIONS

Any condition.

IDEAL FIELD CONDITIONS

Any field condition.

SPECIFICS

Compatible With: D2, FD2, FD2 PLUS

Description	Bundle #	Setup Time	Weight (lbs) (kg)	
15' DK - fine (14) serration	B7223	incl. in base	36	16
20' DK - fine (14) serration	B7224	incl. in base	45	20
25' SK - coarse (9) serration	B6294	incl. in base	50	23
25' SK - coarse (9) serration (set of 2)	B7226	incl. in base	100	45
25' DK - coarse (9) serration	B6297	incl. in base	54	24
30' SK - coarse (9) serration	B6293	incl. in base	56	25
30' SK - coarse (9) serration (set of 2)	B7227	incl. in base	112	51
30' DK - coarse (9) serration	B6300	incl. in base	63	29
35' SK - coarse (9) serration	B6294	incl. in base	64	29
35' SK - coarse (9) serration (set of 2)	B7228	incl. in base	128	58
35' DK - coarse (9) serration	B6302	incl. in base	64	29
40' SK - coarse (9) serration	B6295	incl. in base	72	33
40' SK - coarse (9) serration (set of 2)	B7229	incl. in base	144	65
40' DK - coarse (9) serration	B6303	incl. in base	72	33
41' DK - coarse (9) serration	B6452	incl. in base	73	33
45' DK - coarse (9) serration	B6304	incl. in base	80	36
50' DK - coarse (9) serration	B6453	incl. in base	88	40

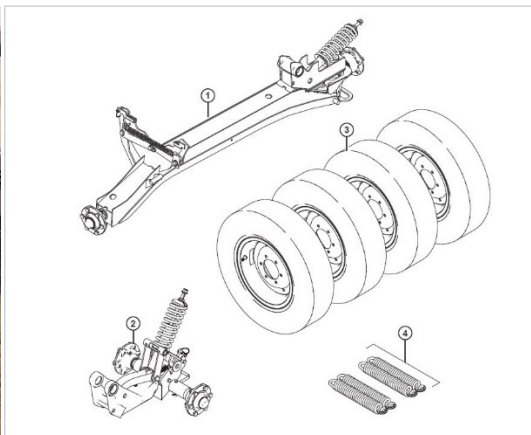

WHAT IT IS/DOES

MacDon's EasyMove™ Transport System makes it easier than ever to move your FD2 Series FlexDraper® from field to field.

This Performance Option is entirely self-contained on the header and allows towing behind your combine at speeds up to 32 km/h (20 mph)*.

Headers equipped with this option also have the advantage of using the spring-loaded stabilizer wheels to help steady the header when cutting off the ground in bumpy field conditions creating an even stubble height.

FEATURES/BENEFITS

- » Transports D2 and FD2 Series headers safely from field to field
- » Prevents the header from bouncing or rocking side to side
- » Allows for an even cutting height when cutting off the ground
- » Locks into a rigid position completely off the ground when they are not in use

Notes:

**Always follow local traffic laws and regulations.*

IDEAL CROP CONDITIONS

Crop conditions where cutting off the ground is necessary.

IDEAL FIELD CONDITIONS

Bumpy field condition.

SPECIFICS

Compatible With:

D2, FD2, FD2 PLUS

Collector Bundle #:

C2048 - FD230 & FD235

C2050 - D230/35/40/41/45 and FD240/41/45/50

Collectors include the following bundles; B6288 (Slow Speed Transport Frame), 2x B6275 (Wheels and Tires), B6382 (Long Tow Pole), B6383 (Short Tow Pole)

Weight:

C2048 – 370 kg (816 lbs) contains:
1 x B6288 – 230 kg (506 lbs); 2 x B6275 – 94 kg (207 lbs); 1 x B7391 – 47 kg (103 lbs)

C2050 – 379 kg (836 lbs) contains:
1 x B6288 – 230 kg (506 lbs); 2 x B6275 – 94 kg (207 lbs); 1 x B7392 – 55 kg (121 lbs)

Dealer Set-Up Time:

1.5 hrs – 2 People required

Instruction #:

214571

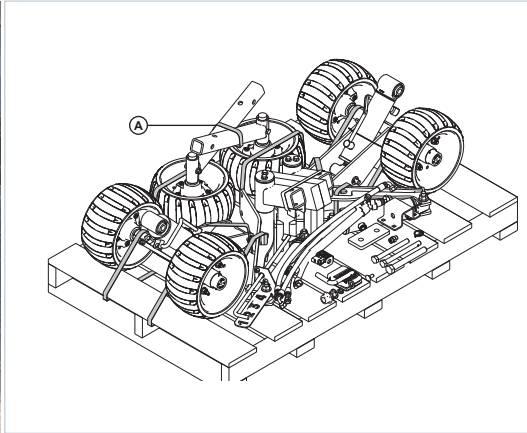

IDEAL CROP CONDITIONS

Any crop type where longer stubble heights are required.

IDEAL FIELD CONDITIONS

Any field condition.

Notes:

**True stubble height range varies slightly depending on combine brand.*

WHAT IT IS/DOES

Take FlexDraper® Performance Over the Top! The ContourMax Performance Option is a hydraulic system that uses strategically placed wheels under the FlexDraper. This design takes full advantage of the FlexDraper's Flex/Float system mirroring the contours of the field while cutting up to 18 inches from the ground surface. Using ContourMax sets you up for next year's seeding with a consistent even stubble height.

FEATURES/BENEFITS

- » Takes full advantage of the FlexDraper's Flex/Float system mirroring the contours of the field while cutting up to 18 inches from the ground surface
- » Stubble heights between 25.4 mm (1 inch) and 457 mm (18 inches) from the ground surface*
- » Adjustable in-cab and on-the-go
- » Height sensing package for John Deere X9 combines. Adds the ability to have preset heights with your AHHC programmed.

SPECIFICS

Compatible With:

FD2, FD2 PLUS

Bundle #:

B7389

Weight:

241 kg (531 lbs)

Set-Up Time:

4 hrs (Completion), 3 hrs (Hydraulics),
2 hrs (JD Sensing Package)

Instruction #:

215022 (Completion Kit), 215291 (Hydraulic Lines)

**Hydraulic line kits needed for headers WITHOUT factory installed plumbing*

Description	Bundle #	Setup Time (hrs)	Weight (lbs)	Weight (kg)
30' Hydraulic Lines	B7082	3	82	37
35' Hydraulic Lines	B7083	3	86	39
40' Hydraulic Lines	B7113	3	86	39
41' Hydraulic Lines	B7114	3	85	39
45' Hydraulic Lines	B7193	3	89	40
50' Hydraulic Lines	B7116	3	91	41
ContourMax Height Sensing (JD X9 Only)	C2101	2	9	4

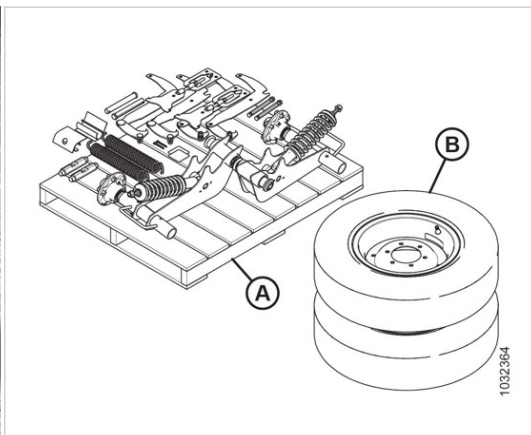

WHAT IT IS/DOES

Spring-loaded stabilizer wheels help to steady the header when cutting off the ground in bumpy field conditions creating an even stubble height.

FEATURES/BENEFITS

- » Prevents the header from bouncing or rocking side to side
- » Allows for an even cutting height when cutting off the ground
- » Locks into a rigid position completely off the ground when they are not in use

IDEAL CROP CONDITIONS

Crop conditions where cutting off the ground is necessary.

IDEAL FIELD CONDITIONS

Bumpy field condition.

SPECIFICS

Compatible With:

D2, FD2, FD2 PLUS

Bundle #:

C2051 – Includes B6460 (Supports & Hubs), and B6275 (Wheels & Tires)

Weight:

C2051 – 159 kg (350 lbs) contains:
1 x B6460 – 109 kg (240 lbs);
1 x B6275 47 kg (103 lbs)

Set-Up Time:

1 hour

Instruction #:

214954

Full Length Upper Cross Auger

MacDon



WHAT IT DOES

The upper cross auger attaches in front of the backtube and improves crop feeding into the center of the header in heavy crop conditions. It is ideal for high-volume harvesting of forages, peas, canola, mustard and other tall, bushy, hard to feed crops. It prevents crop from balling up on the drapers and flowing over the backtube.

FEATURES/BENEFITS

- » Moves heavy, bushy, high-volume crops to the center of the header for smooth feeding
- » Variable pitch flighting at the center of the auger aggressively drives crop into the combine
- » Features a shut-off valve to disengage the drive when the auger is not required
- » Upper Cross Auger speed is relative to side draper speed
- » True full width auger
- » Three piece auger flexes at wing pivots

IDEAL CROP CONDITIONS

High volume and bushy crop conditions.

IDEAL FIELD CONDITIONS

Any field condition.

SPECIFICS

Compatible With:

D2, FD2, FD2 PLUS

Instruction #:

214973 (Completion Kit),
215294 (Hydraulic Plumbing)

Description	Bundle #	Completion Time (hrs)	Weight (lbs)	Weight (kg)
15' One Piece	B7290	3	153	69
20' One Piece	B7291	3	180	82
25' Two Piece	B6413	3.5	281	127
30' Two Piece	B6414	3.5	312	142
35' Two Piece	B6415	3.5	343	156
40' Three Piece	B6417	4	370	168
41' Two Piece	B6416	3.5	360	163
45' Three Piece	B6418	4	420	191
50' Three Piece	B6419	4	468	212
15' Hydraulic Lines	B7270	1	31	14
20' Hydraulic Lines	B7271	1	34	15
25' Hydraulic Lines	B7272	1	38	17
30' Hydraulic Lines	B7117	1	41	19
35' Hydraulic Lines	B7118	1	45	20
40' Hydraulic Lines	B7119	1	49	22
41' Hydraulic Lines	B7120	1	45	20
45' Hydraulic Lines	B7119	1	49	22
50' Hydraulic Lines	B7121	1	54	24

**Hydraulic line kits needed for headers WITHOUT factory installed plumbing*

VertiBlade™ Vertical Knives

MacDon

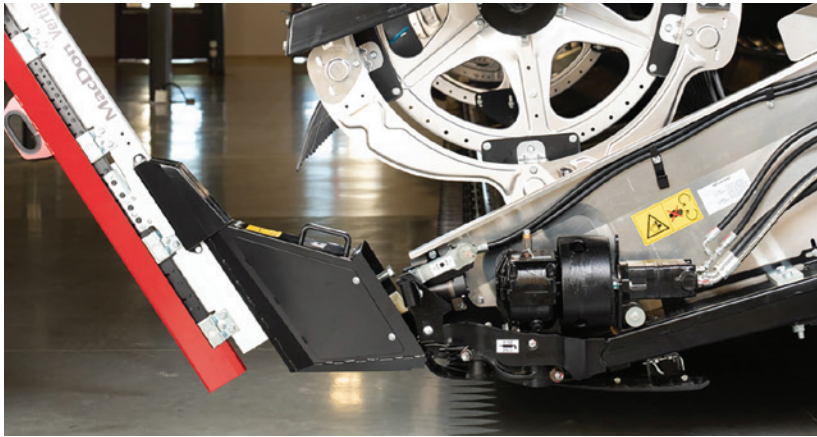

SPECIFICS

Compatible With:

D2, FD2, FD2 PLUS

Bundle #:

B7029

Weight:

156 kg (344 lbs)

Set-Up Time:

2 hours

Instruction #:

215293 (Hydraulics), 215042 (Completion)

WHAT IT DOES

Vertical knives significantly reduce seed shatter loss from dividing interferences of the standard crop dividers and allow for consistent dividing in all conditions. The vertical knife attaches to a MacDon designed mount that fits on the header ends.

FEATURES/BENEFITS

- » Quick attach and removal, hydraulically driven allows for adjustable speed
- » Motor stays mounted low on the header
- » No hydraulic hoses to connect. Hoses remain on the header.

IDEAL CROP CONDITIONS

Canola and oilseed rape, or any other bushy, tangled crop.

IDEAL FIELD CONDITIONS

Any field condition.

Description	Bundle #	Setup Time (hrs)	Weight (lbs)	Weight (kg)
15' Hydraulic Lines	B7274	3	38	17
20' Hydraulic Lines	B7275	3	41	19
25' Hydraulic Lines	B7276	3	43	20
30' Hydraulic Lines	B7127	3	46	21
35' Hydraulic Lines	B7128	3	48	22
40' Hydraulic Lines	B7129	3	56	25
41' Hydraulic Lines	B7130	3	57	26
45' Hydraulic Lines	B7195	3	60	27
50' Hydraulic Lines	B7131	3	63	29

**Hydraulic line kits needed for headers WITHOUT factory installed plumbing*

Hydraulic Reservoir Fill Extension

MacDon®



WHAT IT DOES

The Hydraulic Reservoir Fill extension kit allows D2 and FD2 Series headers to operate on steep hillsides while maintaining oil supply to the suction side of the pump.

FEATURES/BENEFITS

» Prevents the pump cavitating at extreme angles

Notes:

Recommended if operating in conditions with hills exceeding 5°, recommend ordering Side-Hill Stabilizer with the purchase of a Hydraulic Reservoir Fill Extension.

IDEAL CROP CONDITIONS

Any crop condition.

IDEAL FIELD CONDITIONS

Hilly terrain field condition.

SPECIFICS

Compatible With:

FM200

Bundle #:

B6057

Weight:

2 kg (4 lbs)

Dealer Set-Up Time:

45 min

Instruction #:

215875

Rock Retarder Kit

MacDon®

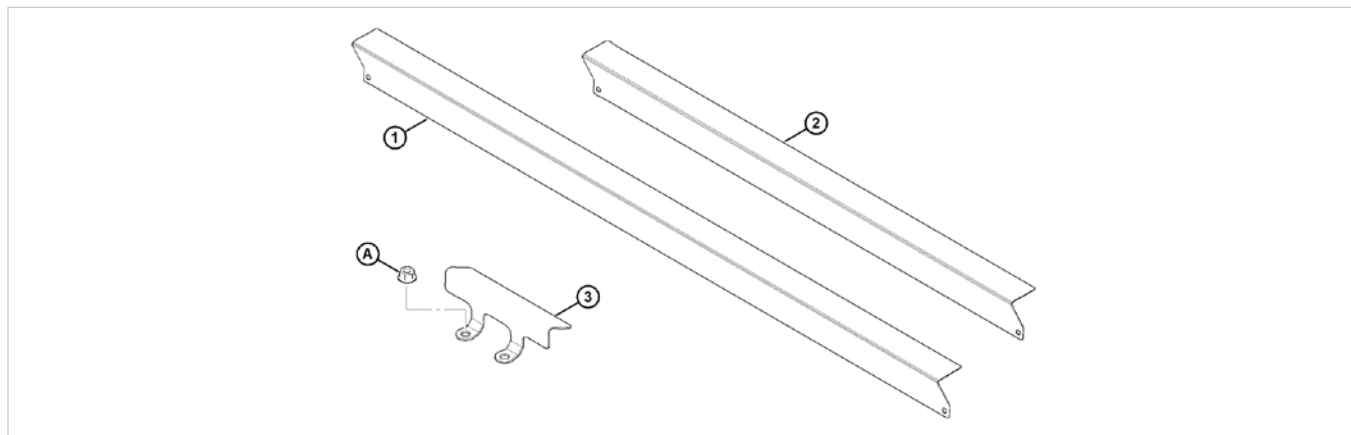

WHAT IT DOES

The rock retarder kit is ideal for situations where cutting low is necessary in rocky field conditions. In these rocky conditions, this kit will help prevent rock ingestion by preventing most stones up to the size of a baseball from getting onto the drapers.

FEATURES/BENEFITS

- » Allows ground level cutting in rocky field conditions
- » Prevents most smaller rocks from getting onto the drapers and into the combine
- » Compatible with both Pointed and PlugFree Guards

Notes:

This kit may impede crop flow in short crops.

IDEAL CROP CONDITIONS

Most crop conditions.

IDEAL FIELD CONDITIONS

Rocky field conditions.

SPECIFICS

Compatible With:

D2, FD2, FD2 PLUS

Bundle #:

(25', 30', 35', 41')	B7122
(40', 45', 50')	B7123

Weight:

(25', 30', 35', 41')	20 kg (43 lbs)
(40', 45', 50')	23 kg (50 lbs)

Dealer Set-Up Time:

1 hour

Instruction #:

215280

High Wear Skid Shoes

MacDon®

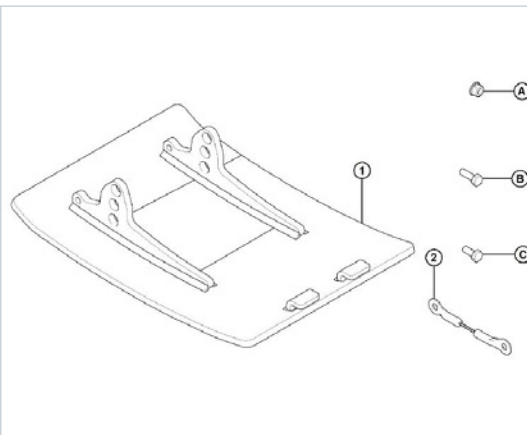

WHAT IT DOES

The High Wear Skid Shoes kit provides extended wear skid shoes for use in rocky, abrasive conditions.

FEATURES/BENEFITS

- » Quick attach. Intended to replace existing polyethylene skid shoes

Notes:

This kit is not recommended for use in wet mud or in conditions vulnerable to sparking (flint rock).

IDEAL CROP CONDITIONS

Normal dry conditions.

IDEAL FIELD CONDITIONS

Rocky, abrasive soil conditions.

SPECIFICS

Compatible With:

D2, FD2, FD2 PLUS

Bundle #:

B6801

Weight:

31 kg (68 lbs)

Dealer Set-Up Time:

30 min

Instruction #:

214977

Lateral Tilt Module

MacDon®

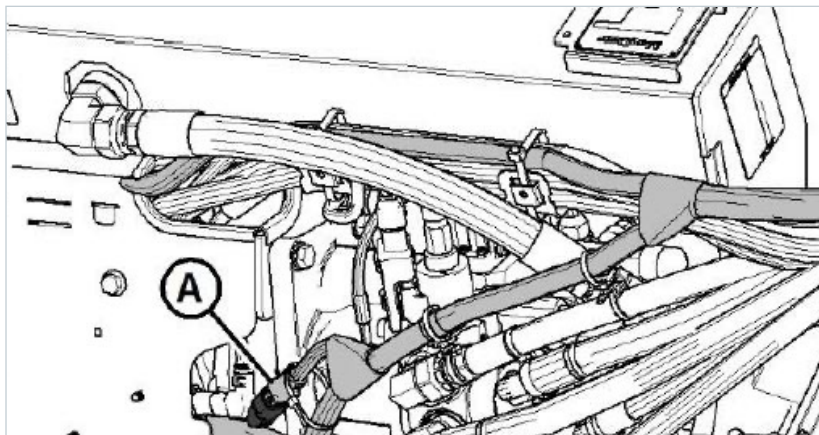

WHAT IT DOES

Kit allows combine lateral tilt to function with AHHC.

FEATURES/BENEFITS

- » Allows for greater automation of the cutting process and better ground following in hilly conditions.

Notes:

Can be used in all conditions.



IDEAL CROP CONDITIONS

Any crop condition.

IDEAL FIELD CONDITIONS

Hilly terrain field condition.

SPECIFICS

Compatible With:

FM200

Bundle #:

B7196

Weight:

1.8 kg (4 lbs)

Dealer Set-Up Time:

30 min

Instruction #:

215331

Floating Crop Dividers

MacDon®



WHAT IT DOES

Replaces the standard crop dividers to provide better ground following to allow for improved dividing in both lodged and standing crops and reduce trampling.

FEATURES/BENEFITS

- » Better ground following
- » Reduced trampling
- » Wide range of adjustment for varying conditions

IDEAL CROP CONDITIONS

Lodged and standing crop.

IDEAL FIELD CONDITIONS

Any field condition.

SPECIFICS

Compatible With:

FD2, FD2 PLUS

Bundle #:

B7346

Weight:

91 kg (200 lbs)

Dealer Set-Up Time:

3 hours

Instruction #:

215827

Rice Divider Rods



WHAT IT DOES

For heavy crop, separates crop at header ends to prevent pushing over.

IDEAL CROP CONDITIONS

Severe lodged rice crop conditions.

IDEAL FIELD CONDITIONS

Wet field condition.

SPECIFICS

Compatible With:

D2, FD2, FD2 PLUS

Bundle #:

B7238

Weight:

11 kg (25 lbs)

Dealer Set-Up Time:

1 hour

PART LIST

289544	LH Rice Divider Rod
289557	RH Rice Divider Rod

Crop Divider Storage Bracket

MacDon



WHAT IT DOES

Divider storage brackets attach to the back of the header. They allow for quick removal and storage of the divider cones and, if required, reduce the transport width of the header.

FEATURES/BENEFITS

- » Allow for quick disconnect of divider cones
- » Divider cones store on the header

IDEAL CROP CONDITIONS

Any crop condition.

IDEAL FIELD CONDITIONS

Any field condition.

SPECIFICS

Compatible With:

D2, FD2, FD2 PLUS

Bundle #:

B7030

Weight:

4.5 kg (10 lbs)

Dealer Set-Up Time:

30 min

Instruction #:

215229

Crop Lifter Kit and Storage Rack



WHAT IT DOES

The crop lifters attach to the cutterbar and are designed to lift downed and lodged crops. For use when the crop is flat to the ground, and some extra lifting action is required, or a taller stubble height is needed. The crop lifter rack comes as a set of two and mounts to the backtube of the header allowing for convenient storage of the crop lifters when they are not in use.

FEATURES/BENEFITS

- » Aids the header in lifting downed and lodged crops
- » Attaches and detaches quickly and conveniently stores on-board with the crop lifter rack

Notes:

Crop Lifter Storage Rack may interfere with other options depending on how the header is configured. For example some configurations that might not work; EasyMove Slow Speed Transport combine extension hitch storage location, crop divider storage bracket, stabilizer/gauge wheel.

Not recommended with the FD2 PLUS

IDEAL CROP CONDITIONS

Lodged cereal crops.

IDEAL FIELD CONDITIONS

Any field condition.

PARTS

Header Model	Number of Kits (B7022) Required
FD230	x3
FD235, FD240, and FD241	x4
FD245 and FD250	x5

SPECIFICS

Compatible With:

D2, FD2

Bundle #:

B7022	Crop Lifters
B7023	Storage Rack

Weight:

12 kg (26 lbs)

Dealer Set-Up Time:

30 min	Crop Lifters
30 min	Storage Rack

Instruction #:

214975	Crop Lifters
214974	Storage Rack

Extended Center Filler

MacDon

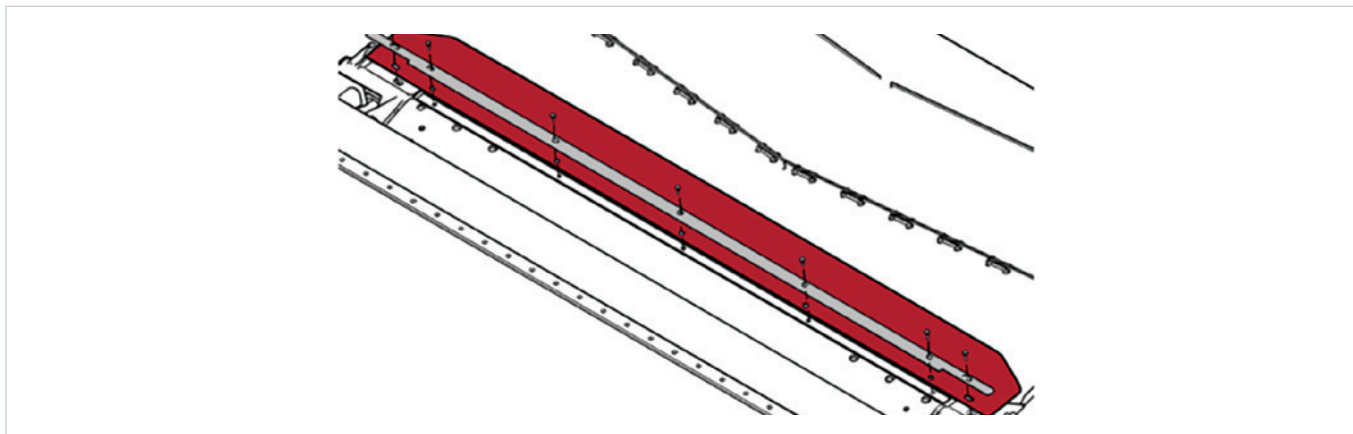

WHAT IT DOES

Extended Center Filler kit is a 3 mm (1/8") thick reinforced flap that extends onto the feed draper of an FM200 Float Module.

FEATURES/BENEFITS

- » To help reduce loss when cutting crops like beans and peas
- » 74 mm longer than standard center filler

IDEAL CROP CONDITIONS

Soybeans, peas and other pulse crops.

IDEAL FIELD CONDITIONS

Any field condition.

SPECIFICS

Compatible With:

FM200

Bundle #:

B6450

Weight:

1.05 kg (2.3 lbs)

Dealer Set-Up Time:

30 min

Instruction #:

214243

Full Interface Filler FD2

MacDon®

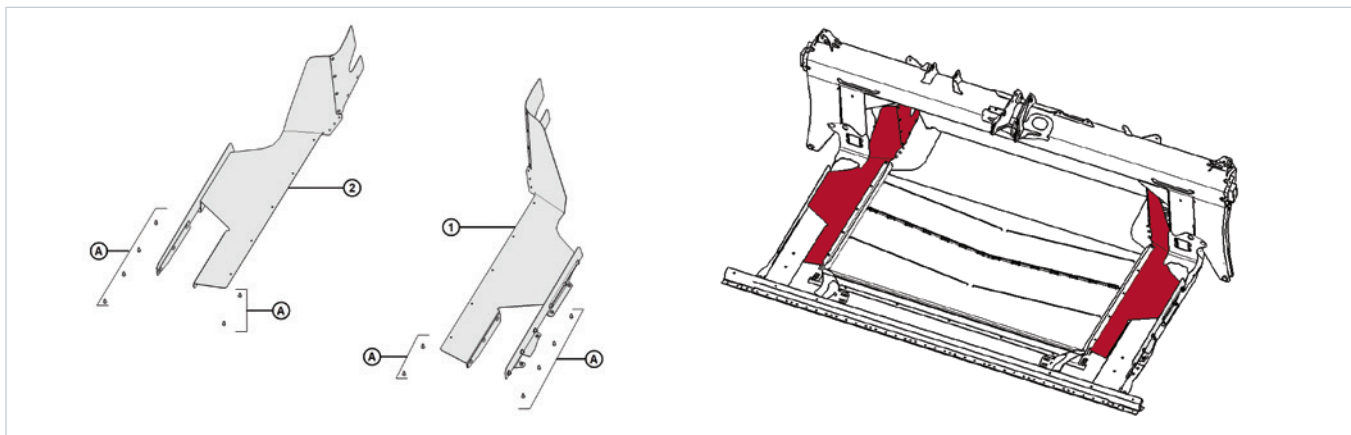

WHAT IT DOES

Provides additional sealing between float module and header.

FEATURES/BENEFITS

» To help reduce loss when cutting crops like beans and peas

IDEAL CROP CONDITIONS

Soybeans, peas and other pulse crops.

IDEAL FIELD CONDITIONS

Any field condition.

SPECIFICS

Compatible With:

FM200 mated with FD2

Bundle #:

B7031

Weight:

6 kg (14 lbs)

Dealer Set-Up Time:

6 hours

Instruction #:

215161

Notes:

Limited availability in North America for 2022. Not compatible with D2.

Stubble Light Kit

MacDon®

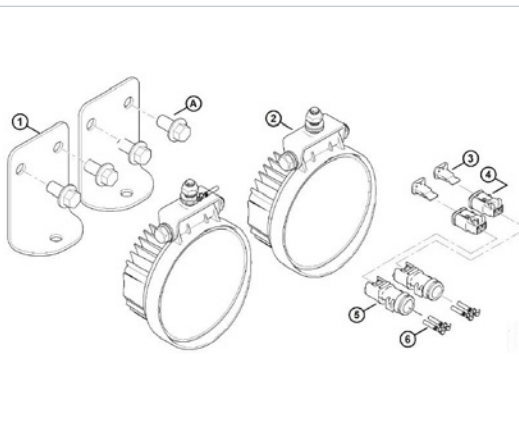

WHAT IT DOES

Exclusive to John Deere combines, the Stubble Light kit consists of two rugged LED lights and brackets. For lighting behind the header outboard of the header legs.

FEATURES/BENEFITS

- » Better visibility in low light conditions
- » Low current draw, under 2 amps each

IDEAL CROP CONDITIONS

Any crop condition.

IDEAL FIELD CONDITIONS

Any field condition.

SPECIFICS

Compatible With:

D2, FD2, FD2 PLUS

Bundle #:

B7027

Weight:

2 kg (5 lbs)

Dealer Set-Up Time:

15 min

Instruction #:

215045

Side-Hill Stabilizer

MacDon®

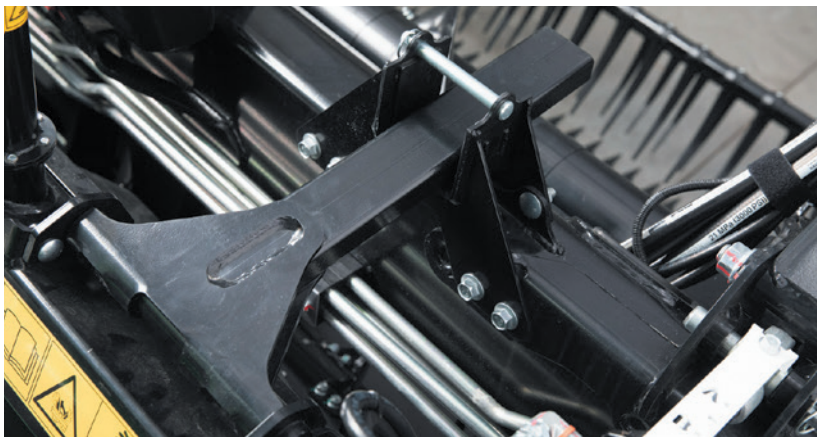

WHAT IT DOES

The Side Hill Stabilizer kit will stabilize the header while on side hills in order to have better ground following capabilities and will function in the same manner on a hill side as it does on level ground. In certain conditions without the side hill stabilizer, the ground following capabilities of the header may be reduced, resulting in crop being missed.

FEATURES/BENEFITS

» Better ground following in hilly terrain.

Notes:

**Recommended if operating in conditions with hills exceeding 5°, recommend ordering Hydraulic Reservoir Fill Extension with the purchase of a Side-Hill Stabilizer. Not needed for D2.*

IDEAL CROP CONDITIONS

Any crop condition.

IDEAL FIELD CONDITIONS

Hilly terrain field condition.

SPECIFICS

Compatible With:

FD2, FD2 PLUS

Bundle #:

B7028

Weight:

10 kg (23 lbs)

Dealer Set-Up Time:

30 min

Instruction #:

215043



WHAT IT DOES

Tine Tube / Reel Conversion kits convert a standard 5 bat (tine tube) reel into a 6 or 9 bat reel.

The additional tine tubes and reel tines allow for a slower reel speed with less load on each individual tine tube; gently lifting delicate or lodged crop.

FEATURES/BENEFITS

» Improves feeding performance in severely lodged or delicate crops.

IDEAL CROP CONDITIONS

Stringy or delicate crops.

IDEAL FIELD CONDITIONS

Any field condition.

SPECIFICS

Compatible With:

D2

Description	Bundle #	USUP (hrs)	Weight (lbs)	Weight (kg)
20' SR 6-9 Bat Plastic Fingers	B7360	4.5	148	67
25' SR 6-9 Bat Plastic Fingers	B7361	5	180	82
30' DR 6-9 Bat Plastic Fingers	B7362	12	240	109
41' DR 5-6 Bat Plastic Fingers	B7359	12	121	55

Header Tilt Footswitch

MacDon®

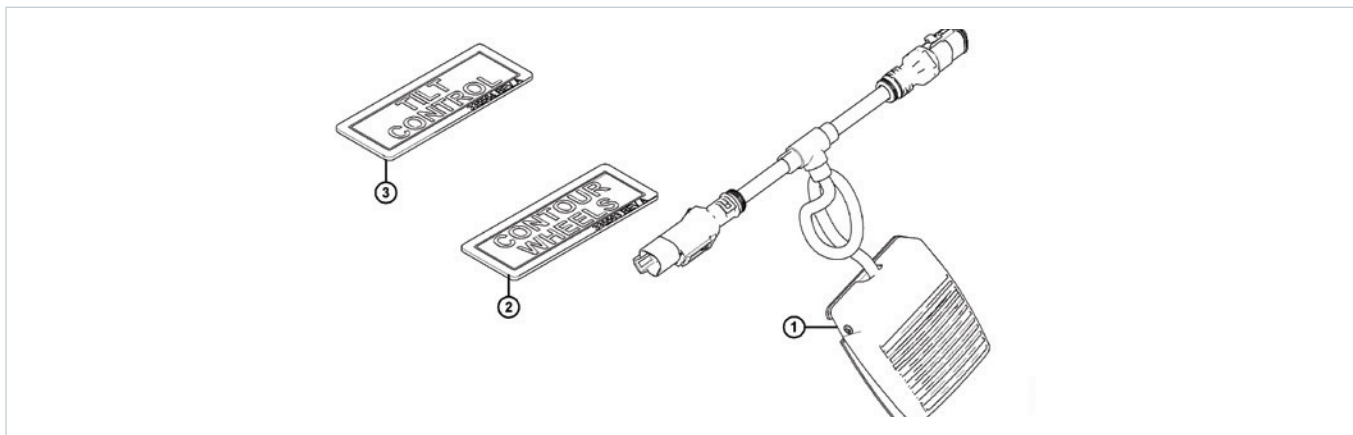

WHAT IT DOES

An alternative to the standard MacDon console toggle, this foot switch is placed on the floor of the cab for foot operation. This allows the operator to change between reel fore/aft and header tilt without taking their hand off the multifunction handle.

FEATURES/BENEFITS

» Allows quick change between controlling reel fore/aft and header tilt.

IDEAL CROP CONDITIONS

Any condition.

IDEAL FIELD CONDITIONS

Any field condition.

SPECIFICS

Compatible With:

D2, FD2, FD2 PLUS

Bundle #:

B7040

Weight:

0.5 kg (1 lb)

Dealer Set-Up Time:

15 min

Instruction #:

215529

Notes:

John Deere and AGCO combines only. In addition to standard rocker switch.

Dual Speed Reel Drive

MacDon

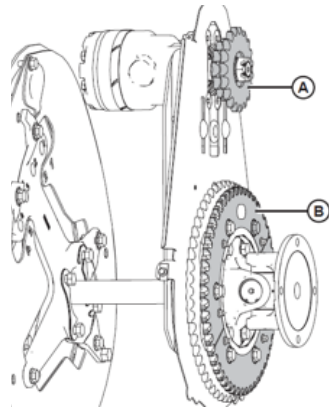

WHAT IT DOES

Replaces standard 19T drive sprocket with optional 10T/20T, 12T/20T, or 14T/20T depending on combine reel drive pressure. Adds additional 52T driven sprocket. Allows operator to choose between two gear ratios depending on crop and conditions.

FEATURES/BENEFITS

» Improves feeding in rice and other specialty crops

PARTS

Sprocket	Reel Circuit Hydraulic Relief Pressure	Combine	Application	Drive Sprocket	Driven Sprocket
Dual Reel Drive Sprocket (A) MD#273451	13.79 MPa (2000 psi)	Case IH, CAT 780, CLAAS 8700, JD 50, 60, 70 Series	Combining down rice	10/20 tooth	Standard (56T)
Dual Reel Drive Sprocket (A) MD#273452	17.24 MPa (2500 psi)	AGCO IDEAL, Massey Ferguson, Gleaner, CAT 500 Series, JD S670, JD S770	Combining down rice	12/20 tooth	Standard (56T)
Dual Reel Drive Sprocket (A) MD#273453	20.68 MPa (3000 psi)	JD S680, JD S780, JD X9, MacDon Swather, New Holland	Combining down rice	14/20 tooth	Standard (56T)
Dual Reel Driven Sprocket (B) MD#311882	NA	All Combines	Combining downed crops and light crops	Select from the options above based on combine	52T

IDEAL CROP CONDITIONS

Green/wet straw conditions and rice.

IDEAL FIELD CONDITIONS

Wet field condition.

Notes:

You can just order the drive sprocket (A) for increased torque, however this will decrease reel top speed.

SPECIFICS

Compatible With:

D2, FD2, FD2 PLUS

Bundle #:

NA, Ordered through parts.

Weight:

273451	1.2 kg (2.5 lbs)
273452	1.3 kg (2.9 lbs)
273453	1.4 kg (3 lbs)
311882	6.8 kg (15 lbs)

Dealer Set-Up Time:

1 hour

Instruction #:

215318

2-Series Sunflower Attachment



WHAT IT DOES

Allows 2-Series Draper headers to productively harvest sunflowers.

FEATURES/BENEFITS

Features	Benefit
Crop Gathering Pans	Capture Sunflower heads to minimize loss to the ground
Adjustable Lean Bar	Leans the plant to be gathered by the reel and minimize reel wrapping
Utilize Full Header Width	Can use a draper header wider than most dedicated Sunflower Headers
Row Width Independent of Design	Do not have to follow the planted rows
Easy Removal for other crops	Pans quick release for easy removal
Lightweight Poly Design	Easier install and removal

Notes:

Not recommend for down crops as the pans can be damaged.

IDEAL CROP CONDITIONS

Standing Sunflower crops.

IDEAL FIELD CONDITIONS

Any field condition.

SPECIFICS

Compatible With:

D2 and FD2 headers with pointed guards only.

Header Size (ft)	Bundle #	Setup Time	Weight (lbs)	Weight (kg)
30	C2086	8	1058	479.9
35	C2087	8.5	1126	510.7
40	C2088	9	1208	547.9
41	Coming Soon			
45	C2089	9.5	1382	626.9
50	Coming Soon			

Instruction:

215909

FM200 Feeding Performance Configurations

MacDon®

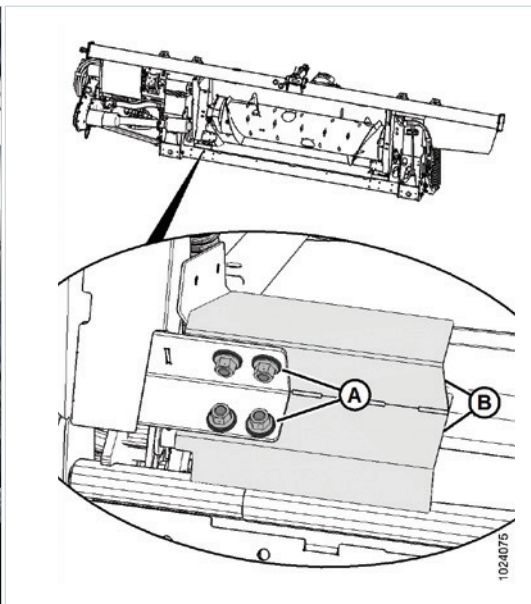
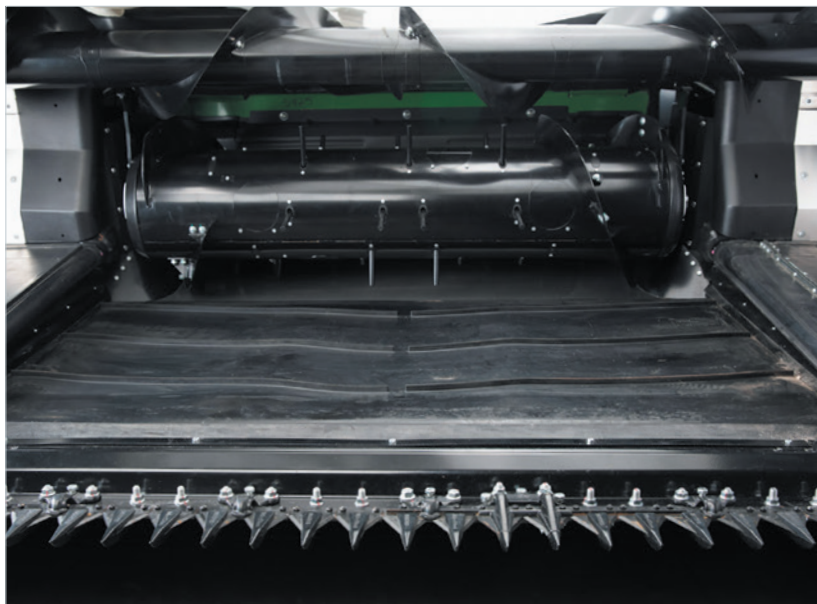

SPECIFICS

Instruction #:

214002 (Auger Flighting), 214170 (Stripper Bar)

WHAT IT DOES

The Feed Auger Flighting Extension kit allows better feeding of crop in green/wet straw conditions and is recommended for rice applications.

Stripper bars can be used to improve feeding in certain crops such as rice. Each stripper bar kit contains one left and one right stripper bar, and the hardware required to attach them to a MacDon FM200 Float Module.

FEATURES/BENEFITS

- » Moves green/wet crop to the center of the feed auger for smoother feeding in these conditions
- » Improves feeding in rice and other specialty crops

IDEAL CROP CONDITIONS

Green/wet straw conditions and rice.

IDEAL FIELD CONDITIONS

Wet field condition.

FM100/FM200 FEED AUGER PERFORMANCE CONFIGURATIONS

U W	Bundle #	Description	Install Time	Weights
	B7343	FINGER BUNDLE FOR FEED AUGER - 4PCS	1 hour	5lb (2kg)
	B7344	SHORT HI-WEAR FLIGHTING FOR FEED AUGER - 2PCS	1.5 hours	20lb (9kg)
	B7345	LONG HI-WEAR FLIGHTING FOR FEED AUGER - 4PCS	1.5 hours	25lb (11kg)
	B7314	CROP DEFLECTORS-ULTRA NARROW FEEDER OPENING WIDTHS OF APPROXIMATELY 35" (896mm)	0.5 hours	30lb (13kg)
	B7347	CROP DEFLECTORS-NARROW FEEDER OPENING WIDTHS OF APPROXIMATELY 44" (1115mm)	0.5 hours	30lb (13kg)
	B7348	CROP DEFLECTORS-MEDIUM	0.5 hours	30lb (13kg)
	B6042	FEEDER OPENING WIDTHS OF APPROXIMATELY 52" (1317mm) STRIPPER BARS - 265 mm LONG	0.5 hours	8lb (3.6kg)
	B6043	FEEDER OPENING WIDTHS OF 52" (1250mm-1350mm) CASE 240-SERIES, CLAAS NARROW BODY, ETC. STRIPPER BARS - 265 mm LONG WITH CUTOUT FEEDER OPENING WIDTHS OF 52" (1250mm-1350mm) FOR JOHN DEERE S-SERIES ONLY	0.5 hours	7.5lb (3.4kg)
	B6044	STRIPPER BARS - 325 mm LONG FEEDER OPENING WIDTH APPROXIMATELY 47" (1197mm)	0.5 hours	9lb (4.1kg)
	B6045	STRIPPER BARS - 365 mm LONG FEEDER OPENING WIDTH OF 44" (1100mm) CASE 2500, ETC.	0.5 hours	10lb (4.5kg)
	B6046	STRIPPER BARS - 403 mm LONG	0.5 hours	11lb (5kg)
	B6213	FEEDER OPENING WIDTH APPROXIMATELY 41" (1041mm) STRIPPER BARS - 515 mm LONG FEEDER OPENING WIDTH APPROXIMATELY 32" (817mm)	0.5 hours	10lb (4.5kg)

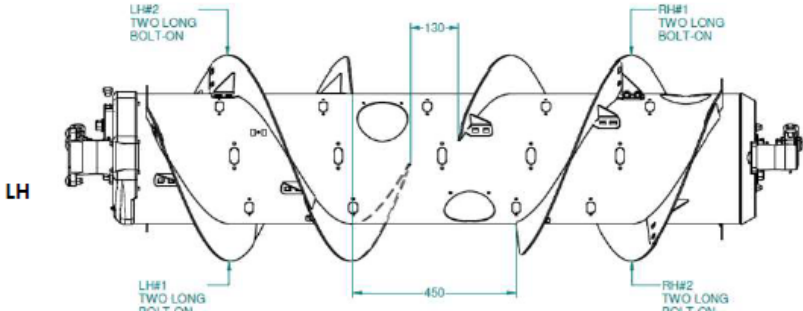
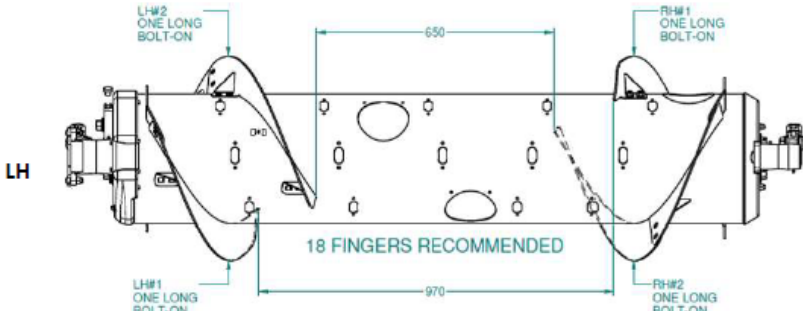
SPECIALTY CONDITION	ULTRA-NARROW	<p>OPTIONAL ULTRA-NARROW CONFIGURATION FOR: RICE HARVESTING</p> <p>NOTE: THIS CONFIGURATION MAY IMPROVE FEEDING PERFORMANCE ON CERTAIN COMBINES WHILE HARVESTING RICE</p>  <p>VIEW FROM REAR</p>	<p>ULTRA-NARROW CONFIGURATION:</p> <p>FINGERS: 18</p> <p>LH #1: 2 LONG FLIGHT</p> <p>LH #2: 2 LONG FLIGHT</p> <p>RH #1: 2 LONG FLIGHT</p> <p>RH #2: 2 LONG FLIGHT</p>
			<p>CONVERTING TO THIS CONFIGURATION:</p> <p>FROM NARROW CONFIGURATION:</p> <p>B7345 (QTY. 1) REQUIRED FOR THIS CONVERSION</p> <ol style="list-style-type: none"> 1. INSTALL ONE LONG RH FLIGHT AT RH#1 (QTY. 1) AND RH#2 (QTY. 1) 2. INSTALL ONE LONG LH FLIGHT AT LH#1 (QTY. 1) AND LH#2 (QTY. 1) - SOME DRILLING WILL BE REQUIRED FOR STEPS 1 AND 2 3. FINGERS CAN BE ADDED OR REMOVED IF NECESSARY (18 RECOMMENDED) <p>FROM MEDIUM, WIDE, OR ULTRA-WIDE CONFIGURATION:</p> <p>B7345 (QTY. 2) REQUIRED FOR THIS CONVERSION</p> <ol style="list-style-type: none"> 1. REMOVE ALL EXISTING BOLT-ON FLIGHTING 2. INSTALL TWO LONG RH FLIGHTS AT RH#1 (QTY. 2) AND RH#2 (QTY. 2) 3. INSTALL TWO LONG LH FLIGHTS AT LH#1 (QTY. 2) AND LH#2 (QTY. 2) - SOME DRILLING WILL BE REQUIRED FOR STEPS 2 AND 3 4. FINGERS CAN BE ADDED OR REMOVED IF NECESSARY (18 RECOMMENDED) <p>OPTIONAL FEED AUGER CROP DEFLECTORS: B7314</p>
NARROW		<p>STANDARD CONFIGURATION FOR:</p> <ul style="list-style-type: none"> • GLEANER: R6/75, R6/76, S6/77, S6/7/88, S96/7/8 • IDEAL: 7/8/9/10 • NEW HOLLAND: CR: 920/940/960, 9020/40/60/65, 6090/7090, 8060/8070/8080 <p>OPTIONAL CONFIGURATION FOR:</p> <ul style="list-style-type: none"> • CASE: 2166/88, 2344/66/77/88, 2577/88, 5/6/7088, 5/6/7130, 5/6/7140, 5/6/7150 	<p>NARROW CONFIGURATION:</p> <p>FINGERS: 18</p> <p>LH #1: 1 LONG FLIGHT</p> <p>LH #2: 1 LONG FLIGHT</p> <p>RH #1: 1 LONG FLIGHT</p> <p>RH #2: 1 LONG FLIGHT</p>
		 <p>VIEW FROM REAR</p>	<p>CONVERTING TO THIS CONFIGURATION:</p> <p>FROM ULTRA-NARROW CONFIGURATION:</p> <ol style="list-style-type: none"> 1. REMOVE ONE LONG RH FLIGHT FROM RH#1 AND RH#2 2. REMOVE ONE LONG LH FLIGHT FROM LH#1 AND LH#2 3. ADDITIONAL FINGERS CAN BE INSTALLED (18 TOTAL RECOMMENDED) <p>FROM MEDIUM, WIDE, OR ULTRA-WIDE CONFIGURATION:</p> <p>B7345 (QTY 1) REQUIRED FOR THIS CONVERSION</p> <ol style="list-style-type: none"> 1. REMOVE ALL EXISTING BOLT-ON FLIGHTING 2. INSTALL ONE LONG RH FLIGHT AT RH#1 (QTY. 1) AND RH#2 (QTY. 1) 3. INSTALL ONE LONG LH FLIGHT AT LH#1 (QTY. 1) AND LH#2 (QTY. 1) 4. EXCESS FINGERS CAN BE REMOVED (18 TOTAL RECOMMENDED) <p>OPTIONAL FEED AUGER CROP DEFLECTORS: B7347</p>

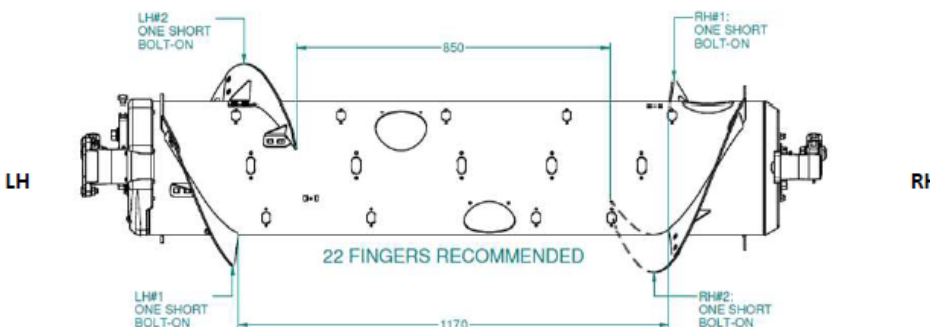
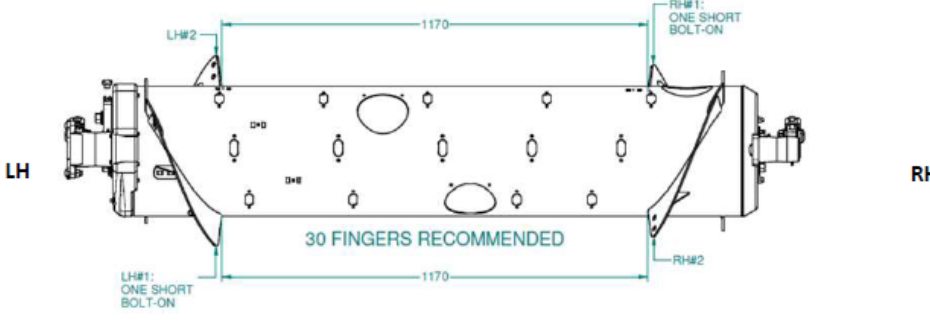
TYPICAL CONDITIONS	MEDIUM	<p>STANDARD CONFIGURATION FOR:</p> <ul style="list-style-type: none"> • CASE: 2166/88, 2344/66/77/88, 2577/88, 5/6/7088, 5/6/7130, 5/6/7140, 5/6/7150, 7/8010, 7/8/9120, 7/8/9230, 7/8/9240, 7/8/9250 • CHALLENGER: 66/67/680B, 54/560C, 54/560E • CLAAS LEXION: 56/57/58/590R, 57/58/595R, 62/63/64/65/66/670, 73/74/75/76/77/780, 6X00, 7X00, 8X00 • FENDT: 9490x, 6335C • GLEANER: A66/76/86 • JOHN DEERE: 95/96/97/9860, 95/96/97/9870, S65/66/67/68/690, T670 • MASSEY: 92/9380, 96/97/9895, 9520/40/60, 9500, 9545/65 • NEW HOLLAND: CR: 970/980, 9070/9080, 8090/9090, X.90, X.80 CX: 8X0, 80X0, 8.X0 • ROSTSELMASH: 161, T500, TORUM 7X0, TORUM 785 	<p>MEDIUM CONFIGURATION:</p> <p>FINGERS: 22</p> <p>LH #1: 1 SHORT FLIGHT</p> <p>LH #2: 1 SHORT FLIGHT</p> <p>RH #1: 1 SHORT FLIGHT</p> <p>RH #2: 1 SHORT FLIGHT</p>
		 <p>VIEW FROM REAR</p>	<p>CONVERTING TO THIS CONFIGURATION:</p> <p>FROM NARROW OR ULTRA-NARROW CONFIGURATION:</p> <p>B7344 (QTY 2) IS REQUIRED FOR THIS CONVERSION</p> <p>B7343 (QTY 1) IS REQUIRED FOR THIS CONVERSION</p> <ol style="list-style-type: none"> 1. REMOVE ALL EXISTING BOLT-ON FLIGHTING 2. INSTALL ONE SHORT RH FLIGHT AT RH#1 (QTY. 1) AND RH#2 (QTY. 1) 3. INSTALL ONE SHORT LH FLIGHT AT LH#1 (QTY. 1) AND LH#2 (QTY. 1) 4. ADDITIONAL FINGERS CAN BE INSTALLED (22 TOTAL RECOMMENDED) <p>FROM WIDE CONFIGURATION:</p> <p>B7344 (QTY. 1) IS REQUIRED FOR THIS CONVERSION</p> <ol style="list-style-type: none"> 1. INSTALL ONE SHORT RH FLIGHT AT RH#2 2. INSTALL ONE SHORT LH FLIGHT AT LH#2 3. EXCESS FINGERS CAN BE REMOVED (22 TOTAL RECOMMENDED) <p>OPTIONAL FEED AUGER CROP DEFLECTORS: B7348</p>
WIDE	WIDE	<p>STANDARD CONFIGURATION FOR:</p> <ul style="list-style-type: none"> • JOHN DEERE: X9: 1000, 1100 <p>OPTIONAL CONFIGURATION FOR:</p> <ul style="list-style-type: none"> • CLAAS LEXION: 590R/595R, 660/670, 760/770/780, 6X00, 7X00, 8X00 • CHALLENGER: 670B/680B, 540C/560C, 540E/560E • JOHN DEERE: T670 • NEW HOLLAND: CX: 8X0, 80X0, 8.X0 • MASSEY: 9895, 9540, 9560, 9545, 9565, 9380 • ROSTSELMASH: 161, T500, TORUM 785 <p>NOTE: THIS CONFIGURATION MAY INCREASE COMBINE CAPACITY ON WIDE FEEDER-HOUSE COMBINES IN CERTAIN CROP CONDITIONS</p>	<p>WIDE CONFIGURATION:</p> <p>FINGERS: 30</p> <p>LH #1: 1 SHORT FLIGHT</p> <p>LH #2: EMPTY</p> <p>RH #1: 1 SHORT FLIGHT</p> <p>RH #2: EMPTY</p>
		 <p>VIEW FROM REAR</p>	<p>CONVERTING TO THIS CONFIGURATION:</p> <p>FROM NARROW OR ULTRA-NARROW CONFIGURATION:</p> <p>B7344 (QTY 1) IS REQUIRED FOR THIS CONVERSION</p> <p>B7343 (QTY 3) IS REQUIRED FOR THIS CONVERSION</p> <ol style="list-style-type: none"> 1. REMOVE ALL EXISTING BOLT-ON FLIGHTING 2. INSTALL ONE SHORT RH FLIGHT AT RH#1 3. INSTALL ONE SHORT LH FLIGHT AT LH#1 4. ADDITIONAL FINGERS CAN BE INSTALLED (30 TOTAL RECOMMENDED) <p>FROM MEDIUM CONFIGURATION:</p> <p>B7343 (QTY 2) IS REQUIRED FOR THIS CONVERSION</p> <ol style="list-style-type: none"> 1. REMOVE ONE SHORT RH FLIGHT FROM RH#2 2. REMOVE ONE SHORT LH FLIGHT FROM LH#2 3. ADDITIONAL FINGERS CAN BE INSTALLED (30 TOTAL RECOMMENDED) <p>FROM ULTRA-WIDE CONFIGURATION:</p> <p>B7344 (QTY 1) IS REQUIRED FOR THIS CONVERSION</p> <ol style="list-style-type: none"> 1. INSTALL ONE SHORT RH FLIGHT AT RH#1 2. INSTALL ONE SHORT LH FLIGHT AT LH#1

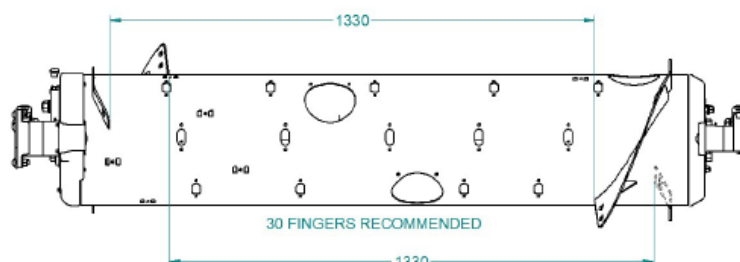
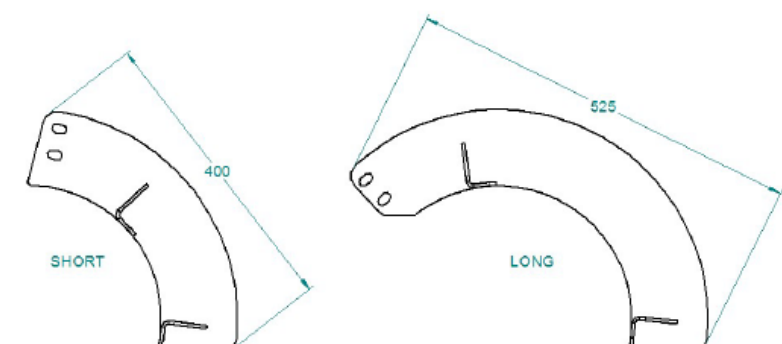
SPECIALTY CONDITION	ULTRA-WIDE	OPTIONAL ULTRA-WIDE CONFIGURATION FOR: WIDE FEEDERHOUSE COMBINES NOTE: IN SOME CONDITIONS FEEDING MAY BE FURTHER IMPROVED BY REMOVING ALL BOLT-ON FLIGHTING.		ULTRA-WIDE CONFIGURATION: FINGERS: 30 LH #1: EMPTY LH #2: EMPTY RH #1: EMPTY RH #2: EMPTY	
		LH		RH	CONVERTING TO THIS CONFIGURATION: FROM NARROW OR ULTRA-NARROW CONFIGURATION: B7343 (QTY 3) IS RECOMMENDED FOR THIS CONVERSION 1. REMOVE ALL EXISTING BOLT ON FLIGHTING 2. ADD FINGERS IF REQUIRED TO REACH RECOMMENDATION OF 30 FROM MEDIUM CONFIGURATION: B7343 (QTY 2) IS RECOMMENDED FOR THIS CONVERSION 1. REMOVE ALL EXISTING BOLT ON FLIGHTING 2. ADD FINGERS IF REQUIRED TO REACH RECOMMENDATION OF 30 FROM WIDE CONFIGURATION: B7343 (QTY 1) IS RECOMMENDED FOR THIS CONVERSION 1. REMOVE ALL EXISTING BOLT ON FLIGHTING 2. ADD FINGERS IF REQUIRED TO REACH RECOMMENDATION OF 30
FLIGHTING IDENTIFICATION					



MacDon[®] *The Harvesting Specialists.*

MacDon.com